

LLOYTRON®

LINKABLE | WIRELESS
MIP™ SYSTEM 3

OPERATING INSTRUCTIONS

Wireless Kit Plug-in Door Chime



MODEL: B7531

thank you

Thank you for the purchase of this quality **LLOYTRON MIP SYSTEM 3™** product. Used carefully and in accordance with the instructions enclosed, it should give you trouble free performance over a long period of time. Please retain these instructions for future reference.

CONTENTS

Features	Page 3
Specifications	Page 3
Out of Box	Page 4
Important Safeguards and Precautions	Page 5
Wireless Distance	Page 6
What is the MIP System™?	Page 7
Linkable Solution	Page 7
The Generation Gap	Page 8
How do I know what Generation I have?	Page 9
Location of Controls	Page 10
Operation	Page 11
Installing the Receiver	Page 11
Installing the Bell Push	Page 12
Different tune different bell push	Page 14
Trouble Shooting	Page 16
Link/Programme Devices	Page 17
Factory Reset	Page 18
Cleaning and Care	Page 19
Weeee/Environmental Protection	Page 19
Customer Service	Page 20

FEATURES

- 32 Tunes
- Mains Operated
- 200m wireless range
- 80dB Sound
- Full Volume Control
- Strobe effect
- Replay Current Tune
- Forward and Back Tune selection
- IP44 Waterproof Bell Push

SPECIFICATIONS

- Operating Voltage: 220-240v ~ 50/60Hz
- Power Output: 0.7w Max
- Operating Frequency: 433.33Mhz
- Noise Output: 80dB
- Bell Push requires: 1x 12v A23 battery (included)
- Chime Unit for indoor use only
- Bell Push is IP44 rated for outdoor or indoor use

■ 32 CHIME SOUNDS

Each tune has been custom-selected for the UK market giving high quality sounds which are relevant for everyday use.

The 32 melodies include:

1-6	Tubular Bell Ding Dongs
7-11	Ding Dong
12	Big Ben Strikes
13	Big Ben Chimes
14-18	Church bell chimes
19-20	Buzzers
21-25	Festive: Happy Birthday, Halloween, and Christmas
26-31	Sound Effects: Dog Bark, Door Knock, Air Raid Siren
32	Security: "Stop Thief" message

OUT OF BOX

Inside this box;

- 1x Waterproof Bell Push transmitter
- 1x Chime Receiver unit
- 1x A23 12v battery for Bell Push
- 1x Operating Manual

This MIP System 3™ Door Chime kit is already pre-programmed for use straight out of the box. Remember to insert the A23 battery with correct polarity into the Bell push transmitter before use. In the unlikely event that the kit does not operate, see the Trouble Shooting section in this manual.

IMPORTANT SAFEGUARDS AND PRECAUTIONS

SAVE THESE INSTRUCTIONS

- Read all instructions carefully
- For Household use only
- The receiver is for indoor use only
- To prevent against the risk of electric shock, do not submerge and part of this appliance in water.
- This appliance is not intended for use by persons with reduced physical, sensory or mental capabilities, or lack of experience and knowledge, unless they have been given supervision or instruction concerning use of this product, by a person responsible for their safety.
- Children should be supervised to ensure they do not play with this appliance.
- Cleaning and user maintenance should not be made by children.
- Never let children push anything into holes or slots in the cabinet – this could result in an electric shock.
- Before plugging into a mains socket, check whether the supply voltage and current rating are in compliance with rating electrical parameters shown on the rating label.
- Should you find the range sensitivity or quality of sound deteriorating, replace old batteries with new ones as soon as possible. The use of long life Alkaline batteries is recommended.
- Dispose of old batteries carefully and in accordance with local government guidelines.

DO NOT

- Do not leave the receiver outside or use in damp conditions
- Do not use rechargeable batteries
- Do not mix old and new batteries or different chemistry of batteries.
- Do not use for any purposes other than the intended use.
- Do not use if damaged in any way.
- Do not dismantle. There are no serviceable parts.

WIRELESS DISTANCE

This wireless Door Chime has an unobstructed operating distance of 200 meters, but local conditions and the number of walls, doors and material affect this. Metal door frames and other factors may interfere with the signal and reduce the operating distance

RANGE DECREASES WHEN OBSTRUCTED

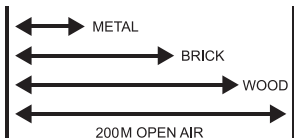

To extend this distance, we suggest using the Signal Booster accessory.

WHAT IS THE MIP SYSTEM™?

The MIP System™ is a wireless audible alert solution with the ability to link additional devices (transmitters, receivers and sensors) to create the perfect combination for your home or business. Create your bespoke alert solution with the MIP System™.

LINKABLE SOLUTION

The MIP System™ provides the solution for many scenarios at home or in a business environment. By linking devices (transmitters, receivers and sensors) it is easy to create a tailor made alert solution, solving common problems such as:

- Need an extra bell push for the back door.
- A portable receiver for the garden party.
- PIR motion sensor on the driveway.
- Wired module to make my old wired system into a wireless version.
- Magnetic sensor on the shed door.
- Wired module so I can continue using my original ornate bell push.

Additional accessories are shown on the back page of this manual.

THE GENERATION GAP

The new MIP System 3™ is the third generation and is compatible with all previous generations, wherever you see these symbols.



The 3rd generation has evolved and offers much more than the previous generation:

- Choose 4 consecutive tunes for different bell pushes or transmitters*
- Longer wireless unobstructed range of 200m for mains operated chime units, 175m for battery operated chime units
- High quality UK customised true sounds
- Ability to link over 16 different devices

Note: * consecutive tune selection is not available for Original MIP, which will only select the default sound on the Chime Unit.

Additional accessories are shown on the back page of this manual.

HOW DO I KNOW WHAT GENERATION I HAVE?

On the rear or side of every Receiver is a Rating Plate as shown.

This Rating Plate will advise a batch number, and/or it will state MIP System 2™ or MIP System 3™.

Products prior to batch 24305 are not compatible with MIP System™.

1st Generation MIP is Batch numbers 24305 to 31838

2nd Generation MIP (MIP System 2™) is Batch numbers 31839 to 33178

3rd Generation MIP (MIP System 3™) is Batch numbers from 33179+

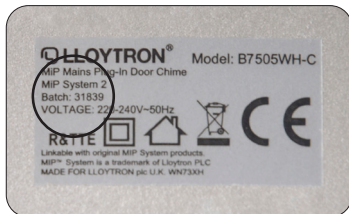

LOCATION OF CONTROLS



A – Chime Replay Button

Pressing this button will repeat the current chime or melody. This button is also used for programming the MIP network.

B – Chime Selection Buttons

This allows users to skip backwards and forwards through the 32 different melodies. Press >| to skip forwards and |< to skip backwards.

C – Variable Volume Control

This allows users to increase or decrease the volume according to requirements. Press + repeatedly to increase the volume and press – repeatedly to decrease the volume.

D – Strobe

Flashing strobes are helpful for the hearing impaired, providing a visual cue when visitors are at the door.

E – Speaker

The speaker outputs the chime or melody audio loudly to indicate that a visitor is at the door.

F – Bell Push

Use the fixtures and fittings provided to position the Bell Push next to the front or back door. Bell Push Requires: 1 x A23 Battery (Included.)

G – Mains Plug

Connect the door chime receiver to a suitable 220-240v~50Hz mains power supply to operate the unit.

OPERATION

■ INSTALLING THE RECEIVER



1. The plug-in Chime Receiver requires a UK mains Socket outlet.



2. Ensure the socket is switched on.



3. Press the Chime Replay ► button to ensure the unit is operating.

Note: the Bell Push and Receiver is already pre-programmed for use straight out of the packaging. There is no need to re-programme unless the memory has been wiped.

■ CHIME REPLAY BUTTON

Pressing the chime replay ► button allows you to check the current melody setting.

⊘ DO NOT

Do not press and hold button, as this will enter Pairing/Programming mode.

■ 32 SOUND SELECTIONS

The main sound selections are made from the Chime Receiver. This will set the Default Sound for the Chime Unit.

There are 32 sounds/melodies to choose. Press ►| button to Skip forwards and |◀ button to skip backwards through the selections. Once you have found the sound you are happy with, simply leave it on that sound until it has stopped playing. The default sound has now been set.

All Bell Pushes/Transmitters that are set to default, or are part of MIP System 1 or 2 will play this sound/melody.

If you wish to activate a different sound for a different bell push/transmitter then see section on "Different Tune Different Bell Push".

■ VARIABLE VOLUME CONTROL

Using the + or – buttons will increase or decrease the volume to the desired level. Once you have found the desired sound level, simply leave it at that volume.

⚠ CAUTION

Listening to high volumes for long periods can cause damage to ears.

■ STROBE

This Door Chime receiver is fitted with a visual flashing LED to attract attention should you be unable to hear the sound.

■ INSTALLING THE BELL PUSH

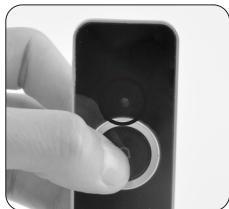

1. Pry open the bell push by inserting a small flat screwdriver in the recess at the bottom of the Bell Push. Do not damage the rubber water seal.

2. Insert 1x 12v DC A23 battery from the packaging, observing the correct polarity as indicated on the bell push and the battery.

3. Press bell push and LED should illuminate.

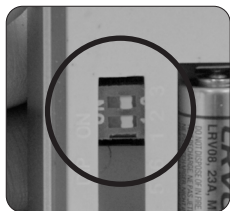

4. If required, change the switch settings as described in section "Different Tune Different Bell Push". If unsure, leave on default setting.



5. Check the rubber seal is intact.



6. Before mounting, ensure the UP arrow is pointing to top of door frame, so unit will not leak.

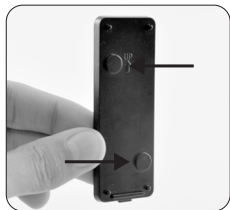

7. If mounting with screws, screw through the holes designated on the backing plate into the door frame.

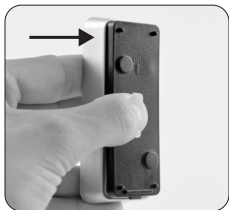

8. Snap back panel back onto bell push observing correct way up on both unit and backing plate.



9. If not mounting with screws, use the self-adhesive pad supplied to attach to the door frame.

DIFFERENT TUNE DIFFERENT BELL PUSH

Inside all MIP System 3™ transmitters (including bell pushes, sensors and modules) you will find a series of switches which allow you to choose one of four consecutive sounds on any compatible chime unit so you can identify which transmitter has been triggered.

You can have up to four chime sounds play on different transmitters, but please note, these chime sounds cannot be chosen at random. Once the default chime sound has been chosen on the chime unit, the next three consecutive sounds in the order they occur on the chime unit can be selected.

Inside the bell push or transmitter casing you will see a red block with two micro switches. Change setting as shown below:

■ DEFAULT SETTING

This default setting is compatible with ALL generations of MIP System™ Door Chimes.



1ST CHIME SOUND

Selecting the default setting on a transmitter will play the default sound chosen on the paired chime unit.

⚠ WARNING

If you are not looking to pair the device with an additional transmitter, or do not want different sounds for different transmitters, please leave transmitter(s) in the default setting.

■ ADJUSTABLE SETTING

Using these settings will only work with MIP System 2™ or MIP System 3™ products. Please check compatibility before use or leave on the default setting.

The sound chosen on the paired chime unit will play when the default setting is in place, to select up to the next three consecutive sounds on the chime unit you will need to move the micro switch to the positions as instructed below.



2ND CHIME SOUND

Position the micro switch as shown in the diagram to set the transmitter to play the 2nd chime sound on the paired chime unit.



3RD CHIME SOUND

Position the micro switch as shown in the diagram to set the transmitter to play the 3rd chime sound on the paired chime unit.

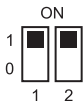

4TH CHIME SOUND

Position the micro switch as shown in the diagram to set the transmitter to play the 4th chime sound on the paired chime unit.

⚠ WARNING

These settings are NOT compatible with non-MIP products or first generation MIP System™ 1, but are compatible with the Second generation MIP System 2™ and Third generation MIP System3™ Door Chimes.

If not compatible, then leave on Default setting otherwise no activation will be made and it will not sound on the chime unit.

See section 'How do I know what generation I have?'

TROUBLE SHOOTING

QUERY	SOLUTION
No blue light on the bell push when pressed.	Check the battery is inserted is correct polarity and is not dead.
No sound when bell push is pressed, bell push illuminates, and Tune sounds when I press chime replay on chime unit.	Check that switch settings inside the bell push are on default. Try to re-link the bell push to the receiver by following the section on link/programme devices.
No sound when bell push is pressed, bell push illuminates, and no tune sounds when I press chime selection on chime unit.	Ensure mains switch is plugged in and switched on at the wall.
Chime unit is activating every few minutes.	Check the bell push switch has not been broken or is sticking or there is water inside the bell push

For further assistance and troubleshooting or on the range of MIP System™ products visit www.doorbellsolutions.com or contact customer services.

LINK / PROGRAMME DEVICES

This process is only necessary when adding additional devices or if the current Bell Push /Transmitters have lost the link to the Chime Units.

Note: for easy programming, keep the bell push and chime unit close together. This saves time and effort.



1. On each chime unit, press and hold the chime replay ► button for 10 seconds. An audible beep beep will be heard. The chime unit is now in a waiting mode for 15 seconds to link the transmitter.

2. Press the bell push or other transmitter. An audible beep will be heard again to advise the bell push or transmitter has been linked successfully.



3. To exit programming mode, press the chime replay ► button again or wait several seconds until a beep beep is heard. The link process has now completed.

4. Press bell push or activate transmitter to trigger the chime unit sound.

If multiple receivers are being used, then each receiver must be programmed to the corresponding bell push individually.

Also refer to individual device manual for accessories before linking.

FACTORY RESET

This process will reset to factory default and clear any linked Bell Pushes/Transmitters to the Chime Unit. It should only be used when you wish to restart the link process for all devices.

Do not use at any other time or your settings will be lost.

Note: for easy reset, keep the Bell Push and Chime Unit close together. This saves time and effort.

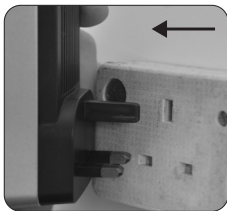

1. With the chime unit plugged into a mains socket, either turn off the mains power at the switch, or remove the chime unit from the mains supply.



2. On the chime unit, press and hold the chime replay ► button.

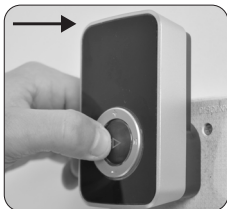

3. Still holding the chime replay ► button, switch on the power at the socket, or plug the chime unit back into the mains socket.



4. Continue to hold the chime replay button for approx. 10 seconds, after which the strobe will flash or an audible beep will sound.

The memory is now clear and all previous devices are no longer linked to this chime unit.

To link new bell pushes/transmitters, see section on 'Link / Programming Devices'

CLEANING AND CARE

Wipe chime unit and bell push with a clean soft lint free cloth to remove dirt and dust.

DO NOT

- Do not use abrasives, detergent or solvent on any surface.

WEEE/ENVIRONMENTAL PROTECTION



■ DISPOSAL OF ELECTRICAL AND ELECTRONIC EQUIPMENT

Do not dispose of this product with household waste. For the proper treatment, recovery and recycling please take this product to the appropriate waste collection point. If you are unsure where this may be, please contact your local authority. Improper disposal may be harmful to the environment.



■ PRODUCT END OF LIFE AND BATTERY DISPOSAL

The battery contains substances that may pollute the environment. At end of life for the product, always remove the battery and separate before you discard the product at your local waste collection point. Both battery and product should be disposed separately.

If you have trouble removing the battery, then you should contact a qualified technician or authorised service centre.

Contact your local authority for details and locations of official waste collection points. Do not dispose of batteries or product with normal household waste.

■ REMOVING THE BATTERY FROM THE BELL PUSH

1. Remove the bell push from the wall or fixture.
2. Pry open the back panel of the Bell Push unit.
3. Remove the A23 battery from the Bell Push unit.
4. Dispose of the battery at an official collection point.

LLOYTRON® CUSTOMER SERVICES

If you have any queries about this product then please contact Lloytron Customer Services online at:



www.lloytronhelpdesk.com

To find out more about Lloytron MIP System products, visit www.lloytron.com



Distributed in UK by Lloytron Ltd, Laltex House, Leigh, England WN7 3XH
Distributed in Europe by Laltex Ireland Ltd, Dublin 2, Eire D02 AY86