

FOR EASY LIVING
homelife[®]

OPERATING INSTRUCTIONS

750w Travel Iron



MODEL: E156

thank you

Thank you for the purchase of this quality **HOMELIFE** product. Used carefully and in accordance with the instructions enclosed, it should give you trouble free service over a long period of time. Please keep these instructions for future reference.

FEATURES

- 750w Power Consumption
- Steam / Shot of Steam and Dry Functions
- Dual voltage: 110-120v / 220-240v AC
- 20ml Water Tank
- Compact design
- Variable Temperature Control
- Non-Stick Soleplate
- Foldable Handle
- Carry Pouch and Filling Jug



SPECIFICATIONS

Operating Voltage: 110-120v / 220-240v~50/60Hz
Power Consumption: 750w Max.



www.lloytronhelpdesk.com

IMPORTANT SAFEGUARDS AND PRECAUTIONS

SAVE THESE INSTRUCTIONS

- Read all instructions carefully
- For Household Use only.
- Only for use indoors.

DO NOT

Do not use outside or in damp conditions.

- Before plugging into mains socket, check whether supply line voltage and current rating are in compliance with the rated electrical parameters shown on the rating label.
- Keep away from hot surfaces, such as gas or electric hobs and ovens etc

DO NOT

Do not use for any purposes other than the appliances intended use.

- This appliance is not intended to be operated by means of an external timer or separate remote control system.
- To prevent damage to the mains cord, do not let it pass over sharp corners, edges or hot surfaces.
- If the supply cord is damaged, do not use. Check before each use!
- The supply cord cannot be replaced. If the cord is damaged the appliance should be scrapped.

DO NOT

Do not use if any part of this appliance is damaged in any way.

- Always unplug when not in use.
- To prevent against the risk of electric shock, do not submerge any part of this appliance in water, unless advised in this manual.
- The iron must be used and rested on a stable surface.

- This appliance can be used by children aged from 8 years and above and persons with reduced physical, sensory or mental capabilities or lack of experience and knowledge if they have been given supervision or instruction concerning use of the appliance in a safe way and understand the hazards involved.
- Children shall not play with this appliance.
- Cleaning and user maintenance shall not be made by children without supervision.





CAUTION: Hot Surface

- The iron must not be left unattended while it is connected to the mains supply.
- Burns can occur from touching the hot metal parts, hot water or steam.
- Allow to cool before storing.
- The plug must be removed from the socket-outlet before the water reservoir is filled with water.
- Push steam button a few times and lightly shake iron after use to ensure all water is drained from reservoir.
- The iron is not to be used if it has been dropped, if there are any visible signs of damage or if it is leaking.
- keep the iron and its cord out of reach of children less than 8 years of age when it is energized or cooling down.

DO NOT

Do not allow children to come in to reach of the cord, even when not in use.

DO NOT

Do not leave unattended while connected to ironing board.

DO NOT

Do not wrap the cord around the iron.

CAUTION

Should be advised when turning the iron upside down as there may be hot water in the water reservoir.

DO NOT

Do not use the iron on the 110v setting when connected to a 220-240v supply as it will damage the product and could cause personal injury.



LOCATION OF CONTROLS



A - Voltage Switch

Switch between 240v for use within the UK or 110v for use in most other countries outside of the UK. Do not attempt to use the iron on the incorrect voltage setting as this could cause damage to the product.

B - Adjustable thermostat control dial

Adjusting the dial allows users to set the temperature to particular settings dependant upon the types of fabrics being ironed.

C - Non-stick soleplate

Pressing the soleplate onto fabrics will iron out creases once the iron has heated up. This iron has a non-stick soleplate, allowing users to iron fabrics without the worry of damaging fabrics.

D - Power cord

Connect the power cord to a suitable 110-120v / 220-240v~50/60Hz mains socket to operate the iron.

E - Folding Handle

Gripping the handle allows users to have greater

stability and control over the iron during use. This handle can be folded down for ease of storage.

F - Handle Fold Button

Pressing this button will allow users to fold the handle down.

G - Shot of steam button

Pressing the shot of steam button will release steam from the iron for a much smoother, crease-free finish to the garments.

H - Removable Water Tank

Remove the water tank in order to fill it with water.

I - Water Tank Release Switch

This switch keeps the water tank locked into place within the handle. Pull the release switch with one hand and remove the water tank with your free hand.



OPERATION

VOLTAGE SELECTION

The iron can be used with either 110-120v or 220-240v AC supply. Use the voltage switch at the back or the iron to toggle between these voltage settings.

⚠ CAUTION

Never connect to supply voltage without checking that the correct voltage setting for the iron has been selected.

⊘ DO NOT

Do not use the iron on the 110v setting when connected to a 220-240v supply as it will damage the product and could cause personal injury.

Note: using the iron on the 220v-240v setting when connected to a 110-120v supply will not damage the iron, but it will take a very long time for the iron to heat up.

FILLING/EMPTYING THE WATER TANK

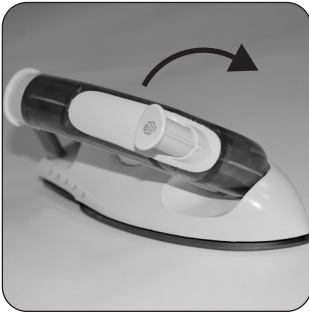

1 LIFT (UNFOLD) the handle until it engages audibly in its fully upright position.



2 REMOVE the water reservoir located in the handle by **PULLING** back the grooved edge of the handle and **LIFTING** the water reservoir (blue coloured handle) out from remaining handle.



3 EMPTY or **FILL** the reservoir and **REPLACE** the reservoir back into handle ensuring that it **LOCKS** into place correctly.

■ BEFORE FIRST USE

1 **BEFORE** using the iron for the first time, **CHECK** if the voltage switch on the base plate corresponds to the mains voltage in your home.

2 **REMOVE** any removable labels or stickers on the iron.

3 Some parts of the iron have been slightly greased during production and as a result the iron may smoke slightly during first use. This is perfectly **NORMAL** and after a short amount of time the smoking will **STOP**.

4 Normal tap water can usually be used for ironing. However, if you live in a hard water area, it is recommended that distilled or de-ionised water is used to ensure optimum performance of this product.

WARNING

The iron must not be left unattended while it is connected to the mains supply.

■ IRONING TIPS

Ironing instructions are usually stitched onto an inside seam of the garment. These instructions should be followed at all times.

1 **SORT** the garments according to the **TYPE** of fabric before ironing.

2 **START** your ironing with the fabrics that require the **LOWEST** heat setting.

3 If you are **UNSURE** of the fabric content of a garment, **TEST** a small area (a seam or inside hem) **BEFORE** ironing.

4 When in doubt, **START** with a low heat. If the wrinkles remain, **GRADUALLY INCREASE** the heat to find the best heat setting for good results without damaging the fabric.

■ USING AS A STEAM IRON

1 **ENSURE** the power cord is **UNPLUGGED** from the mains supply before filling the water tank.

2 **STAND** the iron on the heel rest.

3 **TURN** the adjustable thermostat control dial **ANTI-CLOCKWISE FULLY** to the **'MIN'** position.

4 **FILL** the water tank to the **'MAX'** mark. **DO NOT OVERFILL** past the **'MAX'** mark.

5 **PLUG** the power cord into a suitable mains power supply.

6 Based on the type of fabric being ironed, **ADJUST** the control dial **CLOCKWISE** to the suitable temperature setting and **ALLOW** the iron a few minutes to warm up.



■ USING THE STEAM BUTTON

1 ENSURE that there is water in the tank before attempting to use the steam button.

2 USING the iron **HORIZONTALLY**, **LIFT** the iron and **PRESS** the steam button. You may need to **PRESS** the button a **FEW TIMES** after filling the tank to activate the pump.

***Note:** The steam features can only be used when ironing on high temperature settings.*

■ DRY IRON

The iron can be used as a dry iron, even if there is water in the water tank.

⊘ DO NOT

Do not put water in the water tank if the iron is only being used as a dry iron for many hours at a time.

1 STAND the iron on the heel rest and **PLUG** the power cord into a suitable mains supply.

2 TURN the adjustable thermostat control dial **ANTI-CLOCKWISE** fully to 'MIN'.

3 Based on the type of fabric being ironed, **ADJUST** the control dial **CLOCKWISE** to the suitable temperature setting and allow the iron a few minutes to warm up.

■ CARE AND USE

1 AVOID ironing over zippers, buttons and rivets on jeans etc. as they will **SCRATCH** the soleplate. **IRON AROUND** these types of features instead.

2 Depending upon geographical location, water content can vary widely, as can the mineral content within water. If you live in a **HARD WATER AREA**, it is **RECOMMENDED** that **DISTILLED** or **DE-IONISED** water is used to ensure optimum performance of this product.

⊘ DO NOT

Do not disassemble or attempt to repair the iron yourself.

⊘ DO NOT

Do not wrap the cord around the base of the iron or the heel rest during storage, as this type of manipulation may damage the cord.



■ STORAGE

1 **LEAVE** the iron to cool completely **BEFORE** putting it away into storage.

2 **ENSURE** the water tank is completely empty **BEFORE** storing the iron away.

3 **DO NOT** wrap the power cord around the base of iron during storage.

TEMPERATURE CONTROL

Turn your temperature control dial to the position you desire according to the following fabric indications:

● Synthetics
● Synthétiques
● Chemiefasern

● ● Silk/Wool
● ● Soie/Laine
● ● Seide/Wolle

● ● ● Linen/Cotton
● ● ● Toile/Coton
● ● ● Leinen/Baumwolle

CLEANING AND CARE

■ MAINTENANCE

This appliance has been designed to operate over a long period of time with a minimum of maintenance. Continuous satisfactory operation depends upon proper care and regular cleaning.

WARNING

Before performing any maintenance or cleaning on this appliance, disconnect the appliance from the electricity supply.

■ CLEANING

The exterior surface of the appliance and the soleplate should be cleaned with a clean damp cloth only.

DO NOT

Do not use abrasive cleaners on any part of the appliance.

SPECIAL INSTRUCTIONS

1 To avoid circuit overload, **DO NOT** operate another high wattage appliance on the same circuit at the same time as using the iron.

2 If an extension cord is absolutely necessary, a **13A** cord should be used. Cords rated for less amperage may overheat. Care should be taken to position the cord so that it cannot be pulled or tripped over.



FITTING A NEW UK PLUG

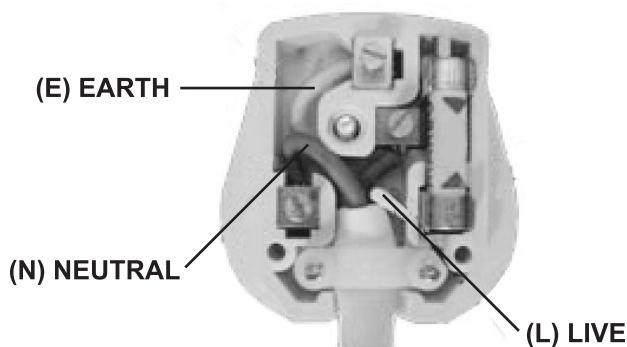

Your appliance operates on 220-240V~50Hz AC Mains and comes fitted with a 3-pin BSI Approved plug, so that it is ready for use for the UK or Eire market. If for any reason you need to fit a new plug, the flexible mains lead must be connected as shown below: -

■ IMPORTANT:

The wires in the mains lead are coloured in accordance with the following code:

BLUE:	NEUTRAL (N)
BROWN:	LIVE (L)
GREEN AND YELLOW:	EARTH (E)

As the colours of the wires in the mains lead of this appliance may not correspond with the coloured markings identifying the terminals in your plug, proceed as follows:

The BLUE wire must be connected to the terminal which is marked with the letter "N" or coloured BLACK.
The BROWN wire must be connected to the terminal which is marked with the letter "L" or coloured RED.
The GREEN AND YELLOW wire must be connected to the terminal which is marked with the letter "E", the symbol  or coloured GREEN.

■ DO NOT CONNECT EITHER WIRE 'L' OR 'N' TO THE EARTH TERMINAL OF A 3-PIN PLUG

Always ensure that the Mains Cord is located into the Plug through the Cord Guard or Cable Clamp, and that the Cord Guard screws are tightened to clamp the Cord (outer sheath and inner coloured wires) in position in the Plug. Make sure the Plug top is also fitted securely.

The supply cord cannot be replaced. If the supply cord is damaged, the appliance should be scrapped.

This appliance must be protected by a 7 Amp fuse in a 13 Amp type (BS1363) plug. Should you need to replace the fuse, use only an ASTA approved BS1362 fuse.





WORLDWIDE TRAVEL USE

Always ensure the correct voltage is in use for the country in which the appliance is being used. For countries that do not use a UK plug, an appropriate earthed travel adaptor must be used.

WEEE/ENVIRONMENTAL PROTECTION



■ DISPOSAL OF ELECTRICAL AND ELECTRONIC EQUIPMENT

Do not dispose of this product with household waste. For the proper treatment, recovery and recycling please take this product to the appropriate waste collection point. If you are unsure where this may be, please contact your local authority. Improper disposal may be harmful to the environment.



FOR EASY LIVING
homelife® CUSTOMER SERVICES

If you have any queries about this product then please contact Lloytron Customer Services online at:



www.lloytronhelpdesk.com

To find out more about Home Life products, visit www.lloytron.com



Distributed in UK by Lloytron Plc, Laltex House, Leigh, England WN7 3XH
Distributed in Europe by Laltex Ireland Ltd, Dublin 2, D02 AY86