

 LLOYTRON[®]

OPERATING INSTRUCTIONS

40w Citrus Press Juicer



MODEL: E5201BK

thank you

Thank you for the purchase of this quality **LLOYTRON** product. Used carefully and in accordance with the instructions enclosed, it should give you trouble free service over a long period of time. Please keep these instructions for future reference.

FEATURES

- 40w Power Consumption
- 1200ml Capacity Bowl
- Clear Lid for easy viewing
- 2 Sized Cones (Large / Small)
- 3 Stage Adjustable Sieve (Small / Medium / Large)
- Safety Cut Out Switch
- Conforms to BS-EN Safety Standards and EMC Regulations



SPECIFICATIONS

Operating Voltage: 220-240v~ 50Hz
Wattage: 40w



IMPORTANT SAFEGUARDS AND PRECAUTIONS



SAVE THESE INSTRUCTIONS

- Read all instructions carefully
- For Household Use only. Not intended for commercial use.
- Only for use indoors.
- Do not use outside or in damp conditions.
- Before plugging into mains socket, check whether supply line voltage and current rating are in compliance with the rated electrical parameters shown on the rating label.
- Keep away from hot surfaces, such as gas or electric hobs and ovens etc
- Do not use for any purposes other than the appliances intended use.
- This appliance is not intended to be operated by means of an external timer or separate remote control system.
- To prevent damage to the mains cord, do not let it pass over sharp corners, edges or hot surfaces.
- If the supply cord is damaged, do not use. Check before each use!
- If the supply cord is damaged, it must be replaced by a special cord or assembly available from the manufacturer or its service agent.
- Do not use if any part of this appliance is damaged in any way.
- Always unplug when not in use.
- To prevent against the risk of electric shock, do not submerge any part of this appliance in water, unless advised in this manual.
- This appliance should only be used on a flat surface.

- This appliance can be used by children aged from 8 years and above and persons with reduced physical, sensory or mental capabilities or lack of experience and knowledge if they have been given supervision or instruction concerning use of the appliance in a safe way and understand the hazards involved.
- Children shall not play with this appliance.
- Cleaning and user maintenance shall not be made by children without supervision.

- Always disconnect the appliance from the supply if it is left unattended and before assembling, disassembling or cleaning.
- Blades are very sharp, even when not in use. Caution should be taken when cleaning or handling blades.
- Ensure correct assembly of all parts before use.
- Blades should be checked regularly for any damage or cracks.
- Do not use when empty or below the minimum mark.
- Do not operate in the presence of flammable fumes or mix flammable materials.
- Do not allow children to use this appliance without supervision.

LOCATION OF CONTROLS

1) Lid

2) Large Cone

3) Juice Jug

4) Small Cone

5) Inner Sieve

6) Motor Stem

7) Outer Sieve

8) Motor Base Unit

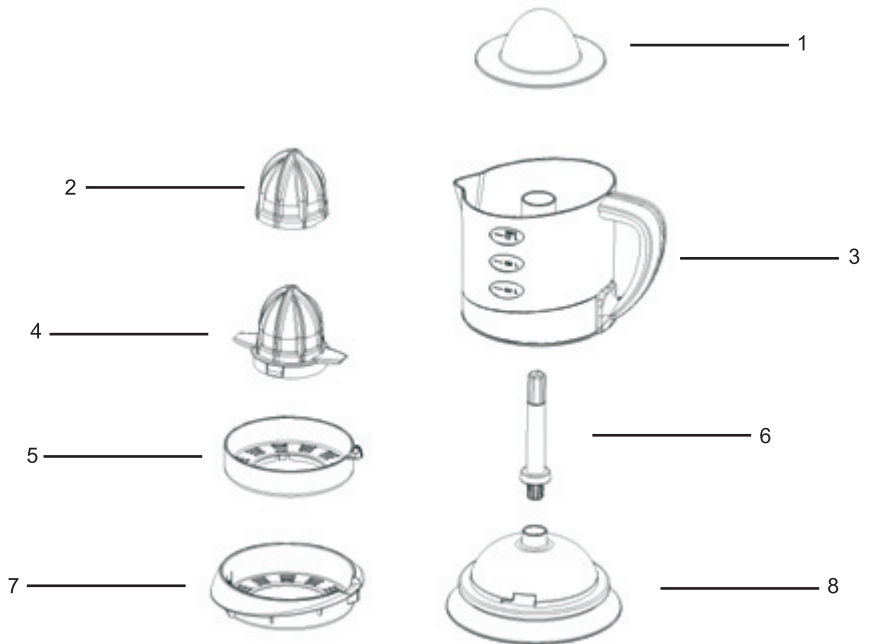

OPERATION



CAUTION!

DO NOT USE CONTINUOUSLY FOR MORE THAN 15 SECONDS.
PAUSE FOR 15 SECONDS BEFORE RE-USING!

PREPARATION BEFORE USE

Before first use, wash the Bowl in warm water, rinse and dry well. Make sure that whenever you use your Juicer it is standing on a flat, clean, dry surface. Before use, please make sure that all parts are correctly assembled.

OPERATION

- 1) Assemble the unit as shown.
- 2) Plug into Mains Outlet.
- 3) Prepare Fruits by washing and cutting in half.
- 4) Remove Lid.
- 5) Select correct size Cone for the Fruit Size. (Pull small cone from inside large cone)
Large Cone = Grapefruits, Oranges etc
Small Cone = Limes, Lemons etc
- 5) Use one hand to hold the base of the juicer, use other hand to press the fruit firmly down onto the cone.
- 6) The motor will operate automatically and will change direction on each operation.
- 7) The Sieve can be adjusted from Small, Medium and Large depending on the size and amount of Fruit Tendons required into the juice.
- 8) Do not use continuously for more than 15 seconds, then pause for 15 seconds.
NOTE: This is to avoid the motor from burning out.
- 9) After use, clean immediately.

CLEANING AND CARE

MAINTENANCE:

This appliance has been designed to operate over a long period of time with a minimum of maintenance. Continuous satisfactory operation depends upon proper care and regular cleaning.

Warning! Before performing any maintenance or cleaning of this appliance, disconnect the appliance from the electrical supply.

CLEANING:

Never put the Motor Unit under a tap or in a dishwasher, but clean it with a damp sponge, and dry thoroughly. The Bowl, Lid, Cones and Sieve can all be washed in hot soapy water and dried with soft clean cloth.

THIS ITEM IS NOT DISHWASHER SAFE

WEEE/ENVIRONMENTAL PROTECTION



Disposal of Electrical and Electronic Equipment

Do not dispose of this product with household waste. For the proper treatment, recovery and recycling please take this product to the appropriate waste collection point. If you are unsure where this may be, please contact your local authority. Improper disposal may be harmful to the environment.

UK PLUG REWIRING

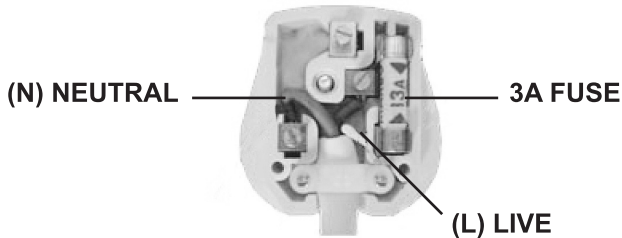

Your appliance operates on 220-240V~50Hz AC Mains and comes fitted with a 3-pin BSI Approved plug, so that it is ready for use by simply plugging into AC Mains. Should you need to change or refit a plug, proceed as follows: -

IMPORTANT:

The wires in the mains lead are coloured in accordance with the following code:

BLUE:	NEUTRAL (N)
BROWN:	LIVE (L)

As the colours of the wires in the mains lead of this appliance may not correspond with the coloured markings identifying the terminals in your plug, proceed as follows:

The BLUE wire must be connected to the terminal which is marked with the letter "N" or coloured BLACK.

The BROWN wire must be connected to the terminal which is marked with the letter "L" or coloured RED.

DO NOT CONNECT EITHER WIRE TO THE EARTH TERMINAL OF A 3-PIN PLUG

Always ensure that the Mains Cord is located into the Plug through the Cord Guard or Cable Clamp, and that the Cord Guard screws are tightened to clamp the Cord (outer sheath and inner coloured wires) in position in the Plug. Make sure the Plug top is also fitted securely.

The supply cord cannot be replaced. If the supply cord is damaged, the appliance should be scrapped.

This appliance must be protected by a 3 Amp fuse in a 13 Amp type (BS1363) plug. Should you need to replace the fuse, use only an ASTA approved BS1362 fuse.



LLOYTRON® CUSTOMER SERVICES

If you have any queries about this product, there are three ways to contact our customer service department:

call: 08454 81 8808

email: customerservice@lloytron.com

web: www.lloytronhelpdesk.com

To find more details on a wide range of Lloytron products please visit our website at www.lloytron.com
Lloytron plc, Laltex House, Leigh Commerce Park, Greenfold Way, Leigh, Lancashire, WN7 3XH. England, U.K