

FOR EASY LIVING  
**homelife**<sup>®</sup>

---

OPERATING INSTRUCTIONS

---

# Cordless Handstick Vacuum

TORNADO CX15



---

MODEL: E8211

---

# thank you

Thank you for the purchase of this quality **HOMELIFE** product. Used carefully and in accordance with the instructions enclosed, it should give you trouble free service over a long period of time. Please keep these instructions for future reference.

---

## FEATURES

---

- Powerful 150w cyclone suction
  - Multi-Surface Hard & Soft Floor Cleaning
  - Lightweight 1.2Kg
  - Wall mountable
  - Easy Empty Bagless Dust Container
  - Washable HEPA Filter Sponge
- Includes:
- High efficiency motorised floor brush
  - Long Crevice tool
  - 2in1 crevice and upholstery tool
  - Washable Hepa/Sponge filter

---

## SPECIFICATIONS

---

- Power: 150w
- Voltage: 220-240v 50Hz
- 2200mAh Lithium Battery
- Dust Cup Capacity: 0.7ltr
- Run Time: 15min approx. on Turbo, 35 min approx. on Normal
- Vacuum Power: 10kPa on Turbo, 8kPa on Normal
- Noise Level: 78 db
- Ambient Operating Temperature: 5°C - 23°C

**Note:** Do not operate if ambient temperature is outside this range as this may damage the product.

---

## IMPORTANT SAFEGUARDS AND PRECAUTIONS

---

### SAVE THESE INSTRUCTIONS

- Read all instructions carefully
- For Household Use only. Not intended for commercial use.
- Only for use indoors.
- Before plugging into mains socket, check whether supply line voltage and current rating are in compliance with the rated electrical parameters shown on the rating label.



- The supply cord cannot be replaced. If the cord is damaged the appliance should be scrapped.

- This appliance can be used by children aged from 8 years and above and persons with reduced physical, sensory or mental capabilities or lack of experience and knowledge if they have been given supervision or instruction concerning use of the appliance in a safe way and understand the hazards involved.
- Children shall not play with this appliance.
- Cleaning and user maintenance shall not be made by children unless they are older than 8 and supervised.
- Keep the appliance and its cord out of reach of children less than 8 years.
- Children from 3 years and less than 8 years shall only switch on/off the appliance provided it is placed or installed in its intended normal operating position and they have been given supervision or instruction concerning the use of the appliance in a safe way and understand the hazards involved.
- Children from 3 years and less than 8 years shall not plug in, regulate and clean the appliance or perform user maintenance.



- Do not use outside or in damp / wet conditions.
- Do not use for any purposes other than the appliances intended use.
- Do not touch the power cord or plug with wet hands.
- Do not use the appliance to vacuum inflammable substances, like cigarettes and hot ashes.
- Keep the openings free to avoid blockage, like hair and loose clothing that may reduce air flow.
- Do not use without filters in place.
- Use extra care when cleaning on stairs. To avoid personal injury or damage, and to prevent the cleaner from falling.
- Do not place cleaner on stairs or furniture, as it may result in injury or damage.
- Do not use to pick up flammable or combustible liquids, such as gasoline, or sawdust or use in areas where they may be present.
- Store the vacuum cleaner indoors. Put the vacuum cleaner away after use to prevent tripping hazards.
- Turn off the appliance before unplugging and after using.
- Never allow children to use this appliance.
- If the appliance or cord is damaged, do not use anymore, It must be repaired by a qualified service agent.
- Never pull the power cord to disconnect the plug attached to this appliance from its mains socket.
- This appliance is not intended to be used with a separate timer or remote control system.
- Do not pull the power cord when detaching from charging station.

## 1

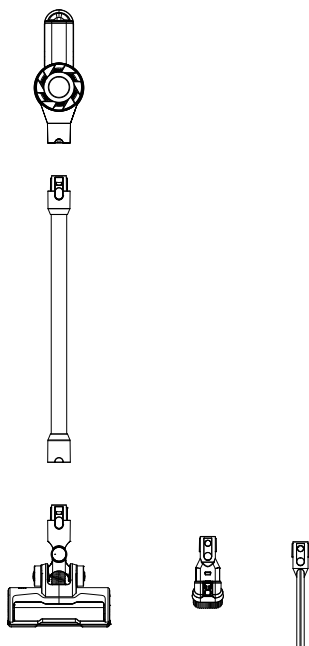

2

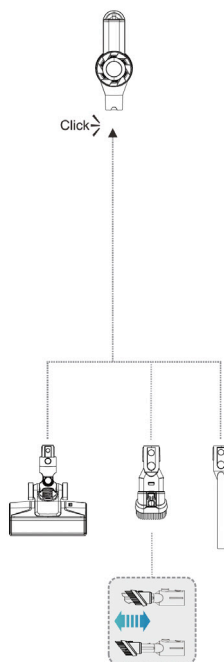

---

## LOCATION OF CONTROLS

---

1 - Main body

2 - Tube

3 - Power brush

4 - 2 in 1 Crevice Tool

5 - Crevice tools

6 - Wall mount

7 - Adaptor

8 - Dust Canister

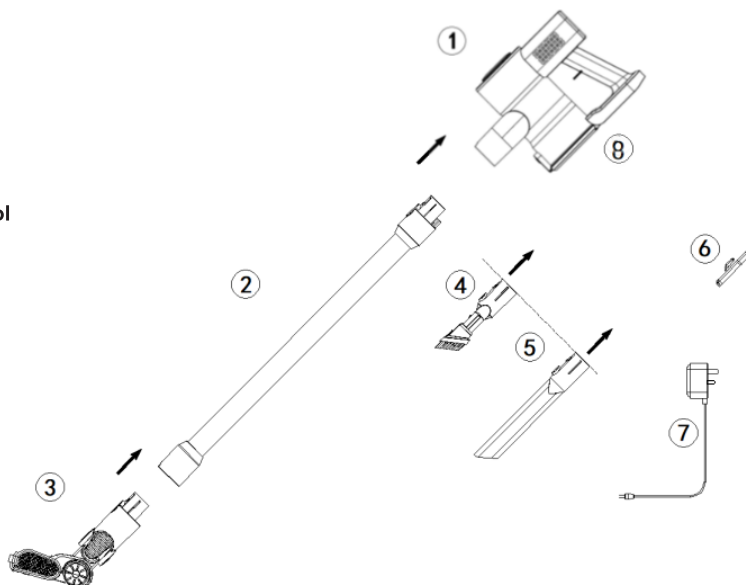

---

## WALL MOUNTING

---

Choose location near power outlet. Locate point high enough on wall to allow tube and power brush to hand freely. Place wall mount against wall and use pencil to mark drill holes. Drill holes( with 1/4"bit ) and insert drywall anchors. Insert screws through holes on mount and tighten until firmly attached.

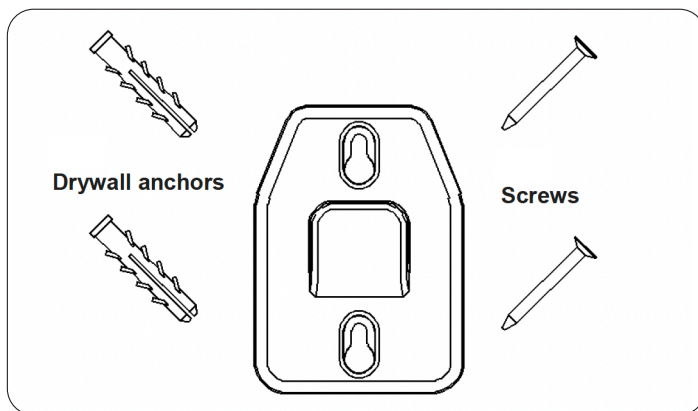

Slide tube onto main body until it clicks

Push tube into power brush or Crevice Tool until it clicks



# OPERATION

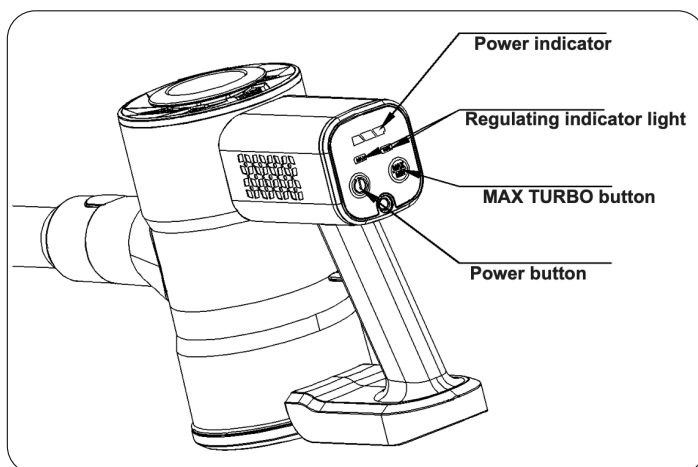

## **⚠ WARNING**

1. Please do not use vacuum with plug connected.
2. Remove the battery before disposal of the vacuum cleaner.
3. The vacuum cleaner must be serviced or repaired by a specialised technician.

## **■ CHARGING**

The battery must be fully charged before the first use. The product is delivered with the battery not charged. Place the product on the wall mount.

1. Connect socket and appliance with adaptor and cord, and power indicator flickers.

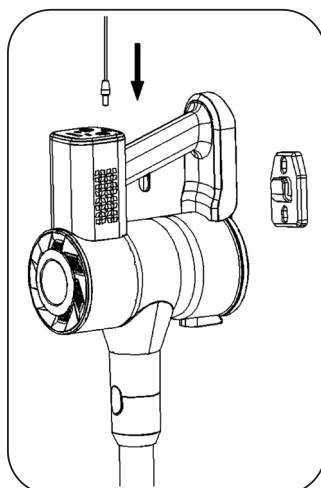

Place main body on flat surface when recharged.

Connect socket and main body with adaptor and cord and power indicator flickers.

**Tip:** In case of dropping appliance should be charged horizontally without brush and extension tube

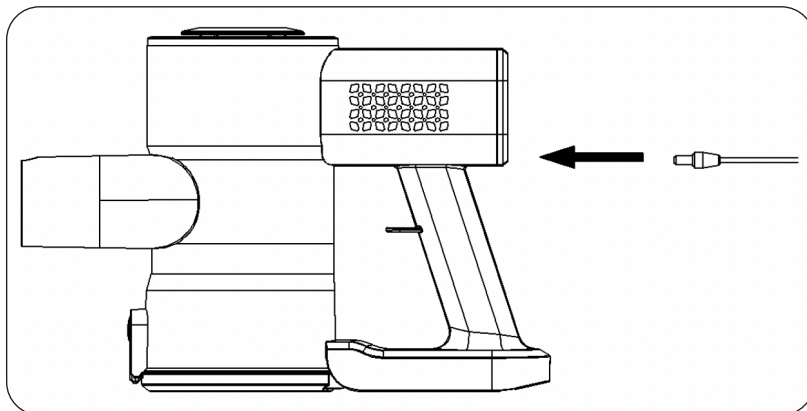

### CHARGING TIME:

General charging time 4-6 hours

### WORKING TIME:

Turbo mode  $\geq 15$  min,

Normal mode  $\geq 35$  min

#### Tips

1. Please do not charge if the ambient temperature is lower than 5 or higher than 40.
2. Insufficient power indicator for quantity of electricity flickers when you get an insufficient power in operation process.

### BATTERY CHARGING:

1. It may take you longer time for charging under the following circumstances :
  - a. Room temperature is higher than 30;
  - b. Recharge immediately after the vacuum cleaner has stopped operating.
2. Always recharge the vacuum cleaner after each usage no matter how long it has been used.
3. Unplug when not charging.
4. When not in use for more than two months the vacuum cleaner should be disconnected from the power supply. To ensure a longer service life, the vacuum cleaner must be charged once every two months.
5. The vacuum cleaner or adaptor may become hot during charging so take the necessary precautions to avoid contact.



---

## USING THE VACUUM

---

To prevent obstructions large pieces (for example big paper scraps, packaging film) should be removed in advance before vacuuming.

1. Click "Power button" for cleaning.
2. Press "MAX" to switch between intense TURBO cleaning and energy savings NORMAL suction modes.
3. Click "Power button" to stop cleaning.

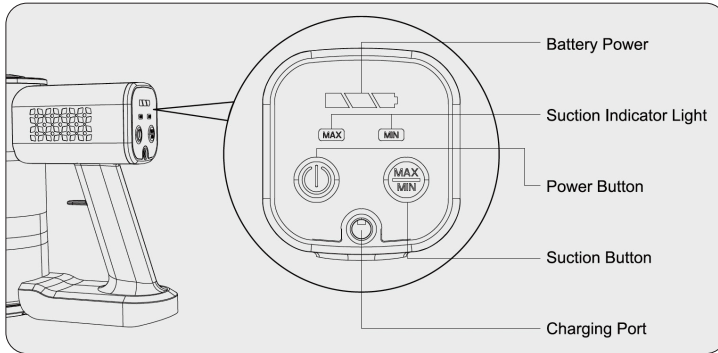

---

## STORAGE

---

Place the product on the wall mount. Connect socket and appliance with adaptor and cord.

---

## DUST REMOVAL & HEPA FILTER CLEANING

---

Please remove the dust regularly to ensure constant suction.

Remove tube before emptying. Hold vacuum over waste basket. Press lever to release bottom lid of dust cup to empty the dust cup.

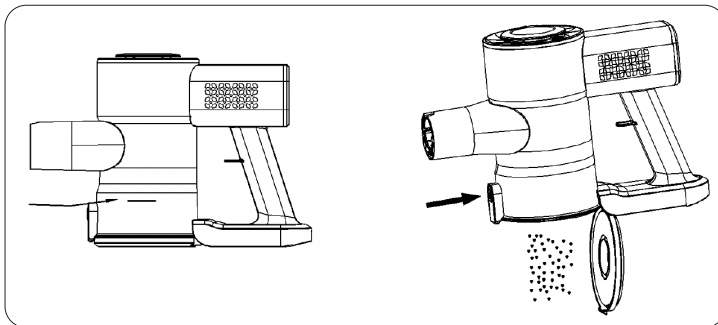



Twist filter clockwise and remove. Lift out filter and carefully remove the stainless steel strainer to expose the HEPA filter.

Remove any debris with a soft brush. Rinse and dry THOROUGHLY. Assemble after each part once dried completely.

## ■ HOW TO DISASSEMBLE HEPA AND STAINLESS STEEL STRAINER

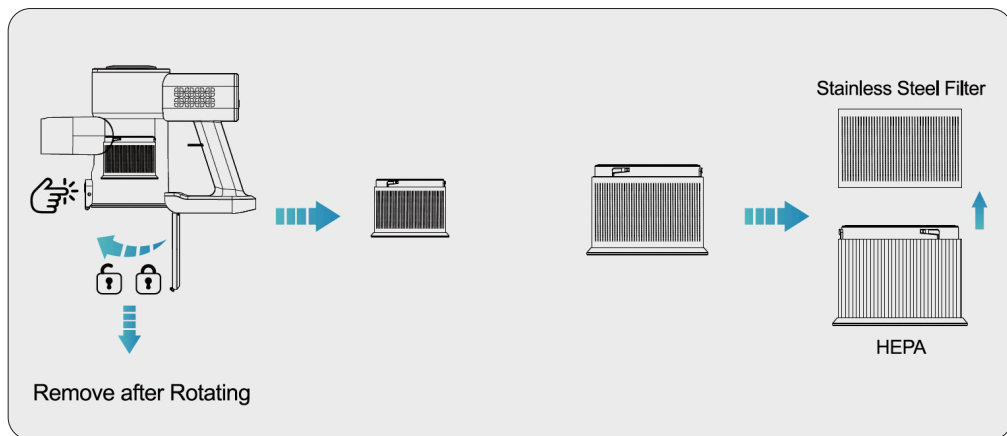

## ■ HOW TO CLEAN HEPA AND STAINLESS STEEL STRAINER

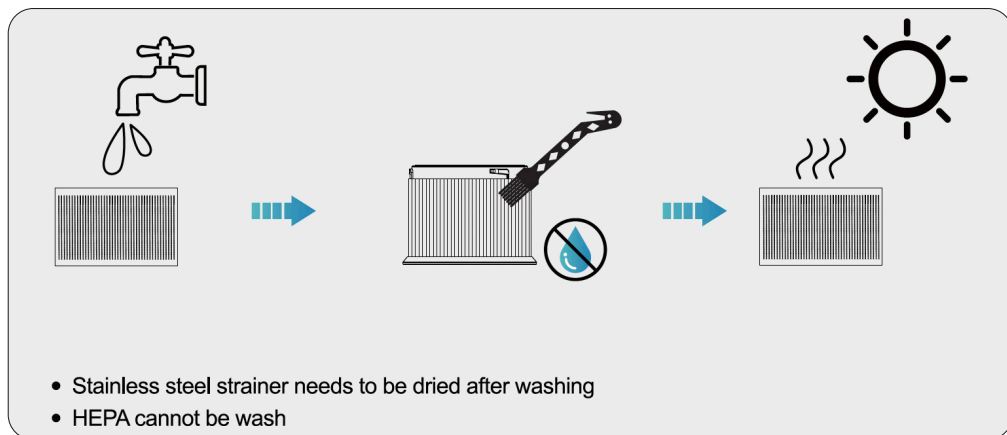

### ⚠ CAUTION

To prevent injuries handle with care.

1. Do not wash the mechanical part of the dust collector.
2. Ensure each part dried completely before next usage.
3. Do not scrub the filter or apply undue force.
4. Ensure filter is correctly secured during assembly.
5. Change filter if damaged or if cleaning does not return it to its original state.



# BRUSH HEAD CLEANING

Please clean the brush when the brush roller or the wheel is entangle by hair.

## 1. Disassemble the power brush.

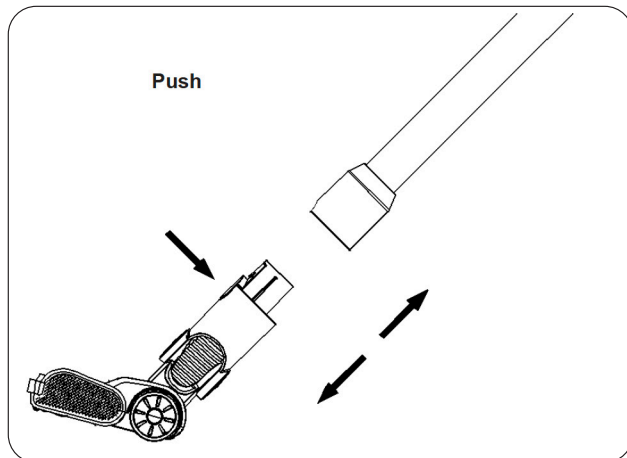

## 2. Using a flathead screwdriver or coin, turn screw to the 'unlock' position. Disassemble brush roll for cleaning and reassemble after all parts are completely dried.

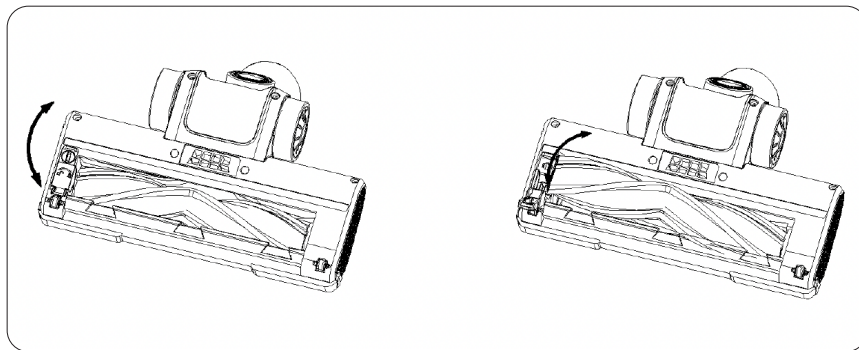

**Tip:** The brush roll and its cover are washable. Ensure they are completely dry before use.

### CAUTION

1. When the dust blocks the air flow of the floor brush please clean it.
2. Except for the brush roller and its cover, all other parts cannot be washed with water.
3. Do not apply oil to both ends of the brush roller.
4. Do not touch the working brush roll part and stay away from the air outlet when in operation.
5. Do not use when wheels or scrubber's nylon loop are damaged.



## TROUBLESHOOTING

PROBLEM	POSSIBLE CAUSES	SOLUTION
3 lamps for power indicator flicker	<ul style="list-style-type: none"> <li>• The rolling bar is wrapped.</li> <li>• Temperature is too high or low.</li> </ul>	<ul style="list-style-type: none"> <li>• Clean the rolling bar.</li> <li>• Move the vacuum to suitable temperature.</li> </ul>
power brush does not work	<ul style="list-style-type: none"> <li>• Brush is trapped by hair or larger debris.</li> </ul>	<ul style="list-style-type: none"> <li>• Ensure that no hair or other thread is trapped around the brush and check brush area for larger debris.</li> </ul>
Running time shortened	<ul style="list-style-type: none"> <li>• Battery needs to be replaced.</li> <li>• Ambient temperature is too high or too low.</li> <li>• Battery is no fully charged.</li> </ul>	<ul style="list-style-type: none"> <li>• Contact the shop or after sales service to replace the battery fat the user's own cost.</li> <li>• Your vacuum should only be operated in suitable ambient temperature.</li> <li>• The battery needs charging.</li> </ul>
The vacuum has no suction power	<ul style="list-style-type: none"> <li>• The dust cup is full.</li> <li>• The filter is blocked.</li> <li>• Suction inlet of brush or other accessory is blocked</li> <li>• Parts of the appliance .is not fully dried after cleaning.</li> </ul>	<ul style="list-style-type: none"> <li>• Clean the dust cup after use to prevent build ups.</li> <li>• Remove any dust or debris from the filter.</li> <li>• Check for blockages at brush and other attachment points.</li> <li>• Ensure that all components are properly dried after washing.</li> </ul>
MAX indicator flickers	<ul style="list-style-type: none"> <li>• The filter or duct are blocked.</li> </ul>	<ul style="list-style-type: none"> <li>• Clean the dust filter, dust cup and air duct.</li> </ul>
No charging	<ul style="list-style-type: none"> <li>• Ambient temperature when charging is too low or too high.</li> </ul>	<ul style="list-style-type: none"> <li>• Charge the machine under the right temperature environment(5°-40°).</li> </ul>

## WEEE/ENVIRONMENTAL PROTECTION



### ■ DISPOSAL OF ELECTRICAL AND ELECTRONIC EQUIPMENT

Do not dispose of this product with household waste. For the proper treatment, recovery and recycling please take this product to the appropriate waste collection point. If you are unsure where this may be, please contact your local authority. Improper disposal may be harmful to the environment.



### ■ PRODUCT END OF LIFE AND BATTERY DISPOSAL

The rechargeable battery contains substances that may pollute the environment. At end of life for the product, always remove the battery and separate before you discard the product at your local waste collection point. Both battery and product should be disposed separately.

If you have trouble removing the battery, then you should contact a qualified technician or authorised service centre.

Contact your local authority for details and locations of official waste collection points. Do not dispose of batteries or product with normal household waste.



---

FOR EASY LIVING  
**homelife**® **CUSTOMER SERVICES**

---

If you have any queries about this product then please contact Lloytron Customer Services online at:



**[www.lloytronhelpdesk.com](http://www.lloytronhelpdesk.com)**

To find out more about HomeLife products, visit [www.lloytron.com](http://www.lloytron.com)



Distributed in UK by Lloytron Ltd, Laltex House, Leigh, England WN7 3XH  
Distributed in Europe by Laltex Ireland Ltd, Dublin 2, D02 AY86