

# STAYWARM®

---

OPERATING INSTRUCTIONS

---

## Electric Heated Foot Warmer



---

MODEL: F2891

---

# thank you

Thank you for the purchase of this quality **STAYWARM** product. Used carefully and in accordance with the instructions enclosed, it should give you trouble free service over a long period of time. Please keep these instructions for future reference.

---

## FEATURES

---

- Soft Microplush Cover with Synthetic Wool Liner
- 3x Heat Settings
- Auto shut off

---

## SPECIFICATIONS

---

- Operating Voltage: 220-240v~50Hz
- Power Consumption: 60w max
- Ambient Operating Temperature: 5°C to 23°C

**Note:** Do not operate if ambient temperature is outside this range as this may damage the product.

---

## IMPORTANT SAFEGUARDS AND PRECAUTIONS

---

### IMPORTANT INSTRUCTIONS . RETAIN FOR THE FUTURE USE

- Read all instructions carefully
- For Household Use only. Not intended for commercial use.
- Only for use indoors.
- Before plugging into mains socket, check whether supply line voltage and current rating are in compliance with the rated electrical parameters shown on the rating label.
- To prevent damage to the mains or controller cord, do not let it pass over sharp corners, edges or become trapped in the bed frame.
- To prevent against the risk of electric shock, do not submerge any part of this appliance in water, unless advised in this manual.
- If any cord is damaged, do not use. Check before each use!
- If any cord is damaged, it must be replaced by a special cord or assembly available from the manufacturer or its service agent.



Not to be used by very young children (0-3 years)



- The appliance can be used by children older than 3 years and younger than 8 years under supervision and with the control always set to minimum temperature value.



Do not insert pins, needles, safety pins or other sharp items on the blanket.

- This appliance can be used by children aged from 8 years and above and persons with reduced physical, sensory or mental capabilities or lack of experience and knowledge if they have been given supervision or instruction concerning use of the appliance in a safe way and understand the hazards involved.
- Children shall not play with this appliance.
- Cleaning and user maintenance shall not be made by children unless they are older than 8 and supervised.

- If this foot warmer is likely to be used for an extended period, for instance by the user falling asleep, controls should be adjusted to LOW setting which is recommended for continuous use. If the foot warmer is used with the controls set to a higher temperature the user may suffer skin burns or heat stroke.
- Ensure all cords and ties cannot cause a risk of entanglement, strangulation, tripping or treading. The user must ensure that excessive ties and electric cords be arranged in a safe way.

#### DO NOT

- DO allow the foot warmer to dry out and cool down completely prior to storage. Also allow the unit to cool down before folding.
- DO store your foot warmer with loose folds and not sharp creases to avoid any damage to the wires. Also ensure items are not placed on the foot warmer while stored.
- DO follow the cleaning and maintenance instructions when washing/storing the heated foot warmer.
- DO turn off the power and remove the plug when foot warmer is not in use and before cleaning. Always turn the power off at the socket before inserting or removing plug. Remove by grasping the plug - do not pull on the cord.
- DO use the foot warmer from a power outlet of the voltage (A.C. only) marked on the electric foot warmer.
- DO use with the controls provided only.
- DO regularly inspect for signs of wear and tear or damage on the heated foot warmer and cord. If signs of deterioration occur, return product to the retailer immediately for inspection.
- DO as parents and guardians, pre-set controls for young children. Ensure children are supervised to ensure that they do not play with the controls.
- DO take care as temperature of surrounding surfaces may increase when the foot warmer is in use.
- DO have the heated foot warmer checked by a qualified person annually.
- DO consider using a safety switch for extra protection, also known as a Residual Current Device (RCD) not exceeding 30mA.



### DO NOT

- DO contact the retailer should the foot warmer cease heating, as it may have endured a fuse or thermal link rupture.
- DO confirm all parts are present prior to storing the packaging. The bag is not a toy and must not be played with as suffocation may occur.
- DO use as an over-throw only.

### WARNING

- Keep the controller/s away from moisture or windows.
- Keep all dogs, cats and other pets away from the foot warmer.
- Make sure the foot warmer and connectors are completely dry after washing and before switching on. We recommend leaving the unit for a further 24 hours once dry before using. When drying, dry on a washing line. Even though the connectors are washable and waterproof, please make sure that the electrical connectors are also upside down to allow any excess moisture to drain from the connector.
- Examine the unit frequently for signs of wear or damage. If there are such signs the unit has been misused or does not work then do not use.
- This appliance must not be used by persons insensitive to heat and other very vulnerable persons who are unable to react to overheating.
- Children under 3 years of age are not to use this appliance due to their inability to react to overheating.
- This foot warmer must not be used by young children over the age of three unless the controls have been pre-set by a parent or guardian, or unless the child has been adequately instructed on how to operate the controls safely.

### DO NOT

- DO NOT switch the heated foot warmer on if it is damp or wet. All parts must be completely dry prior to use.
- DO NOT use the heated foot warmer with an extension cord unless this cord has been checked and tested by a qualified technician or service person.
- DO NOT place the power cord or connector under any stress or strain. The power cord should always remain free from obstructions.
- DO NOT use pins, needles, safety pins or other sharp objects on or near the heated foot warmer where it could cause damage.
- DO NOT dry clean or iron the heated foot warmer.
- DO NOT operate the heated foot warmer with an external timer or separate remote control system.
- DO NOT use the heated foot warmer for any purpose other than its intended use.
- DO NOT place the heated foot warmer on or near a naked flame, heated element, oven or iron as doing so may melt the heating wire insulation.
- DO NOT allow power cord to dangle onto any hot surfaces, over the edge of a table or bench top where it could be damaged or tripped over.
- DO NOT operate the heated foot warmer if it is damaged in any way. If damage is suspected, do not use and immediately return it to the retailer.
- DO NOT immerse any part of the controller, supply cord or plug in water.
- DO NOT ever use a faulty heated foot warmer, especially if it has frayed or damaged cord or cracked or broken plug.
- DO NOT use the heated foot warmer with infants or children under the age of 3, people with disabilities, limited mobility, anyone who cannot operate the controls properly, persons insensitive to heat or anyone with a medical condition such as; high blood pressure, diabetes, high skin sensitivity or those who cannot understand/follow these directions.



## ⊘ DO NOT

- DO NOT allow pets around the heated foot warmer as sharp teeth and claws may puncture the wire insulation/damage the heating wires.
- DO NOT leave the heated foot warmer unattended while in use.
- DO NOT use this unit for medical use in hospitals.
- DO NOT attempt to service this foot warmer
- DO NOT use if the foot warmer cord has been damaged as this may lead to overheating, fire or personal injury.
- DO NOT trap or fold cords between the bed slats, mattress, springs or against walls, footboards or bed frame as this may cause damage to the cord.
- DO NOT use more than one heat source on the bed at the same time, such additional electric blankets, mattress pads, heating pads, hot-water bottles etc.
- DO NOT use the product under a blanket or pillow. The product may get overheated and increase the risk of fire.
- DO NOT use the product if you have injuries or pain in your feet. If in doubt, obtain medical advice before using the product.
- DO NOT use the product if you feel pain during use.
- DO NOT use the product for therapeutic purposes.
- DO NOT use while wearing shoes, slippers or other footwear.
- DO NOT attempt to walk whilst wearing Foot Warmer

Regarding foot warmers intended to be used after preheating, the mains cord must be disconnected from the mains supply after preheating is complete.

## LOCATION OF CONTROLS

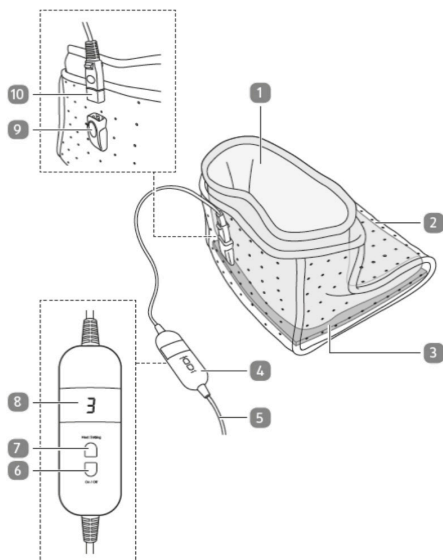

1. Removable Fleece Lining
2. Heating Boot
3. Foam Mat
4. Control Unit
5. Mains Cord
6. On/Off Button
7. Heat Setting Button
8. Display
9. Connection Socket
10. Connection Plug

**NOTE: THE LEAD BETWEEN THE CONTROLLER AND THROW MAY GET WARM DURING USE. THIS IS NORMAL AND SAFE.**



# OPERATION

## ■ USING THE FOOT WARMER

Remove all packaging and inspect for any damage before use.

1. Place the product next to a chair on a level, dry and heat-resistant surface.
2. Put the removable fleece lining 1 into the heating boot 2 .

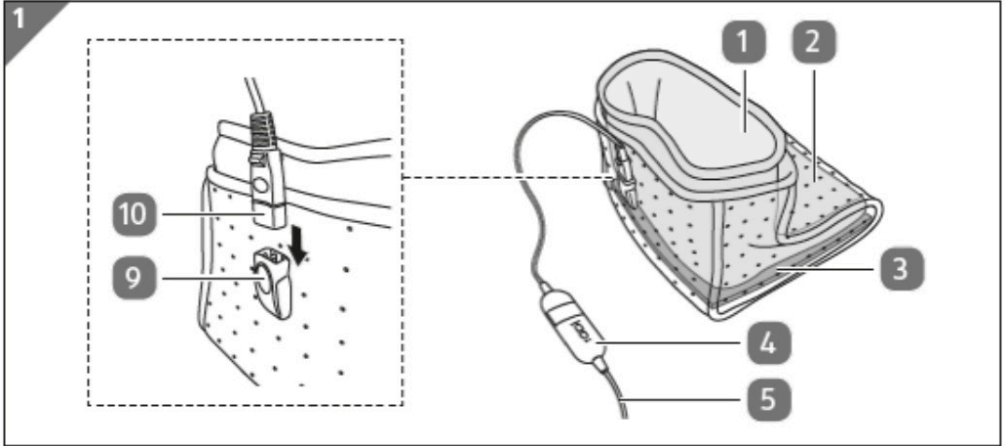

3. Insert the connection plug 10 of the control unit 4 into the connection socket 9 on the heating boot 2 (see Fig. 1).
4. Insert the plug of the mains cord 5 into a mains socket.

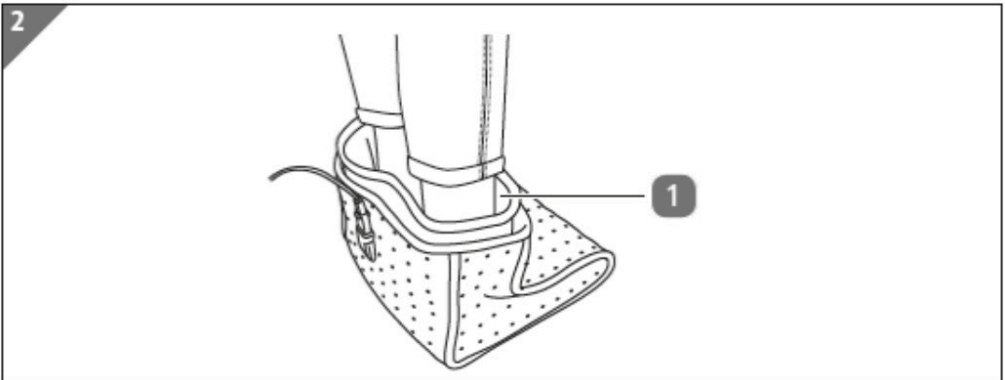

5. Slide your feet into the removable fleece lining 1 and make yourself comfortable (see Fig. 2).
6. Press "Off" button for 2 seconds to turn off the foot warmer.

**NOTE:** Disconnect the mains plug from the mains socket if you are not using the product for a prolonged period.



## ■ WARNING!

Risk of injury and damage!

Improper handling of the product may result in injury and damage to the product.

- Do not insert pins or needles into the product. You may damage the heating wires inside. There is a risk of electric shock and injury.
- Do not operate the product while it is folded or rucked. This may lead to overheating of the product and cause damage.
- The product may emit a faint smell when it is used for the first time. This smell is normal and will disappear over time.
- For your safety, an auto timer switches the product off automatically after 2 hours of continuous operation.

## ■ TURNING THE PRODUCT ON OR OFF

1. Press the ON/OFF button 6 on the control unit 4 to turn the product on (see Fig. 3).

The display 8 illuminates and "3" is shown on the display. By default the product begins to heat up on heat setting 3.

2. Press the ON/OFF button again to turn the product off.

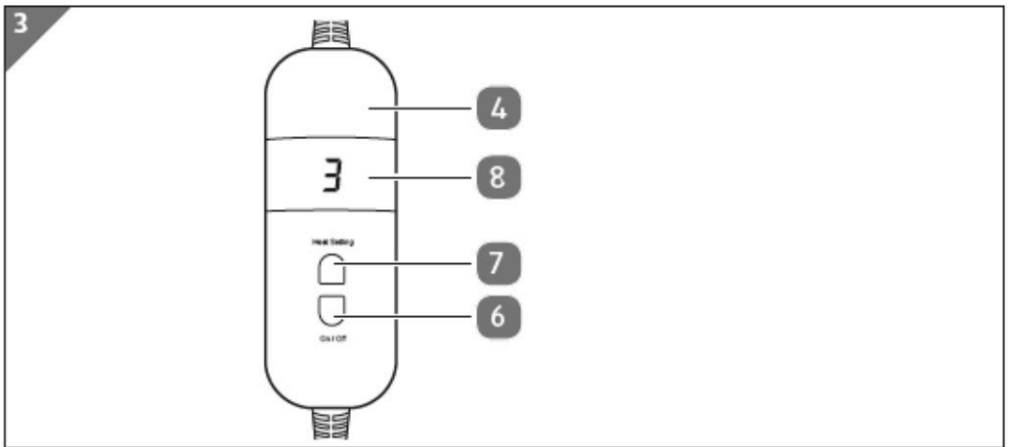

## ■ USING THE HEAT SETTING FUNCTION

- When the product is turned on, it begins to heat up on heat setting 3 by default.
- Press the heat setting button 7 repeatedly to cycle between the available heat settings (see Fig. 3).  
3 = High heat; 2 = Medium heat; 1 = Low heat
- The corresponding heat setting number is shown on the display 8 .



---

## FAULTS AND TROUBLESHOOTING

---

PROBLEM	POSSIBLE REASON	SOLUTION
The product is not working.	The mains plug has not been inserted into a mains socket.	Connect the mains plug to a properly installed mains socket.
	The connection plug <b>10</b> is not plugged into the connection socket <b>9</b> .	Insert the connection plug into the connection socket.

---

## CLEANING AND CARE

---

### ■ WARNING!

#### Risk of electric shock!

Improper handling of the product may result in an electric shock.

- Always unplug the mains plug from the mains socket and disconnect the connection plug from the connection socket before cleaning the product.
- Never immerse the control unit, connection plug, or the connection socket of the heating boot in water or other liquids.
- Do not use the product again until the removable fleece lining and the heating boot have dried completely.
- Do not try to dry the removable fleece lining and the heating boot by turning the product on and heating them up.

### ■ WARNING!

#### Risk of short circuit!

Water or other liquids that have penetrated the exposed electrical parts of the product may cause a short circuit.

- Make sure that no water or other liquids penetrate the control unit, connection plug, or the connection socket of the heating boot.
- Never immerse the control unit, connection plug, or the connection socket in water or other liquids.

### ■ NOTICE!

#### Risk of damage!

Improper handling of the product may result in damage.

- Do not use any aggressive cleaners, brushes with metal or nylon bristles, or sharp or metallic cleaning utensils such as knives, hard scrapers and the like. They could damage the surfaces.
- Special care should be taken when deep cleaning the heating boot. The heating wires inside the heating boot are waterproof, but the controller is not, and can be damaged by water.
  - Do not iron.
  - Do not dry clean.
  - Do not bleach.
  - Do not wring.





## ■ CLEANING THE FLEECE LINING

1. Remove the removable fleece lining 1 from the product.
2. Machine wash the removable fleece lining at or below 40 °C. Alternatively, it can be washed by hand.
3. Dry the removable fleece lining completely before using it again.

## ■ SPOT CLEANING THE HEATING BOOT

1. Unplug the mains plug and disconnect the connection plug 10 from the heating boot 2 . Let the product cool down completely before cleaning it.
2. Sponge the soiled area using mild soapy water. Make sure no water goes into the connection socket.
3. Sponge the area with clean water to rinse.
4. Remove excess water by pressing the area between an absorbent towel.
5. Let the heating boot dry completely before using it again.

## ■ DEEP CLEANING THE HEATING BOOT

1. Unplug the mains plug and disconnect the connection plug 10 from the heating boot 2 . Let the product cool down completely before cleaning it.
2. Except for the connection socket 9 , immerse the heating boot in mild soapy water and allow it to soak for 5 minutes.
3. Take the heating boot out, then gently squeeze the water out of it. Do not wring the heating boot as this may damage the heating wires inside. Make sure no water goes into the connection socket.
4. Rinse the heating boot in clean water, then gently squeeze the water out again.
5. Drape the heating boot across clothes lines and let it drip dry.
6. Do not use the product until the heating boot is completely dry.

## ■ CLEANING THE PLASTIC PARTS OF THE PRODUCT

1. Use a damp cloth to wipe off the plastic parts of the product, such as the control unit 4 and the mains cord 5.
2. Let all parts dry completely before using the product again.

---

## STORAGE

---

### ■ NOTICE!

#### **Risk of damage!**

Improper handling of the product may result in damage.

- Do not crease or weigh down the product by placing other items on top of it during storage. This could damage the network of heating wires inside the product.

All parts must be completely dry before being stored.

- Always let the product cool down completely before storing it.
- Always store the product in a dry area.
- Protect the product from direct sunlight.
- Store the product so that it is not accessible to children.





**DO NOT**

DO NOT BLEACH OR USE DETERGENTS WITH BLEACH



**DO NOT**

DO NOT IRON



**DO NOT**

DO NOT DRY CLEAN



**DO NOT**

DO NOT TUMBLE DRY



**DO NOT**

DO NOT SPIN DRY IN A WASHING MACHINE. FLAT DRY ONLY. DO NOT WRING



**DO NOT**

HAND WASH THE BOOT ONLY



**DO NOT**

MACHINE WASH THE INNER FLEECE LINER – COLD DELICATE/WOOL 30C WASH

**DO NOT**

Do not store the product at temperatures above or below 5°C - 23°C. Failure to comply could result in damage to the product.

---

## WEEE/ENVIRONMENTAL PROTECTION

---



### DISPOSAL OF ELECTRICAL AND ELECTRONIC EQUIPMENT

Do not dispose of this product with household waste. For the proper treatment, recovery and recycling please take this product to the appropriate waste collection point. If you are unsure where this may be, please contact your local authority. Improper disposal may be harmful to the environment.



---

## FITTING A NEW UK PLUG

---

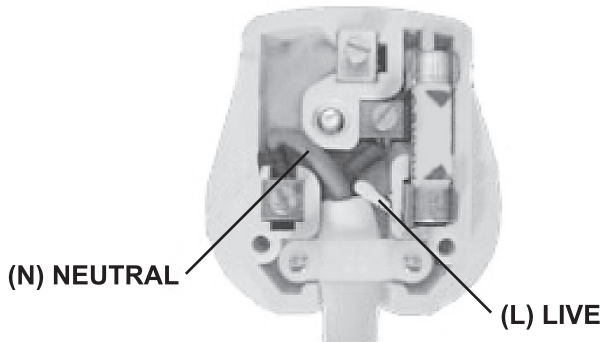

Your appliance operates on 220-240V~50Hz AC Mains and comes fitted with a 3-pin BSI Approved plug, so that it is ready for use for the UK or Eire market. If for any reason you need to fit a new plug, the flexible mains lead must be connected as shown below: -

### ■ IMPORTANT:

The wires in the mains lead are coloured in accordance with the following code:

BLUE:	NEUTRAL (N)
BROWN:	LIVE (L)

As the colours of the wires in the mains lead of this appliance may not correspond with the coloured markings identifying the terminals in your plug, proceed as follows:

The BLUE wire must be connected to the terminal which is marked with the letter "N" or coloured BLACK.  
The BROWN wire must be connected to the terminal which is marked with the letter "L" or coloured RED.

### ■ DO NOT CONNECT EITHER WIRE 'L' OR 'N' TO THE EARTH TERMINAL OF A 3-PIN PLUG

Always ensure that the Mains Cord is located into the Plug through the Cord Guard or Cable Clamp, and that the Cord Guard screws are tightened to clamp the Cord (outer sheath and inner coloured wires) in position in the Plug. Make sure the Plug top is also fitted securely.

The supply cord cannot be replaced. If the supply cord is damaged, the appliance should be scrapped.

This appliance must be protected by a 3 Amp fuse in a 13 Amp type (BS1363) plug.  
Should you need to replace the fuse, use only an ASTA approved BS1362 fuse.



---

## **STAYWARM<sup>®</sup> CUSTOMER SERVICES**

---

If you have any queries about this product then please contact Lloytron Customer Services online at:



**[www.lloytronhelpdesk.com](http://www.lloytronhelpdesk.com)**

To find out more about StayWarm products, visit [www.lloytron.com](http://www.lloytron.com)



Distributed in UK by Lloytron Ltd, Laltex House, Leigh, England WN7 3XH  
Distributed in Europe by Laltex Ireland Ltd, Dublin 2, D02 AY86