



PRO SERIES 1 RECHARGEABLE MENS SHAVER With Trimmer



Model. **H5011**

OPERATING INSTRUCTIONS

INTRODUCTION

Thank you for the purchase of this quality LLOYTRON product.
Used carefully and in accordance with the instructions set out below, it should give you trouble free service over a long period of time.
Please read and keep these instructions for future reference.

FEATURES

- 3w Power Consumption
- Ergonomic Design for easy use
- Titanium Steel Blades
- Fast 8hr Charging Time
- Approx. 40 minute usage time
- Powerful Quiet Motor
- Accessories include: Cleaning Brush and Charging Adaptor

LOCATION OF CONTROLS

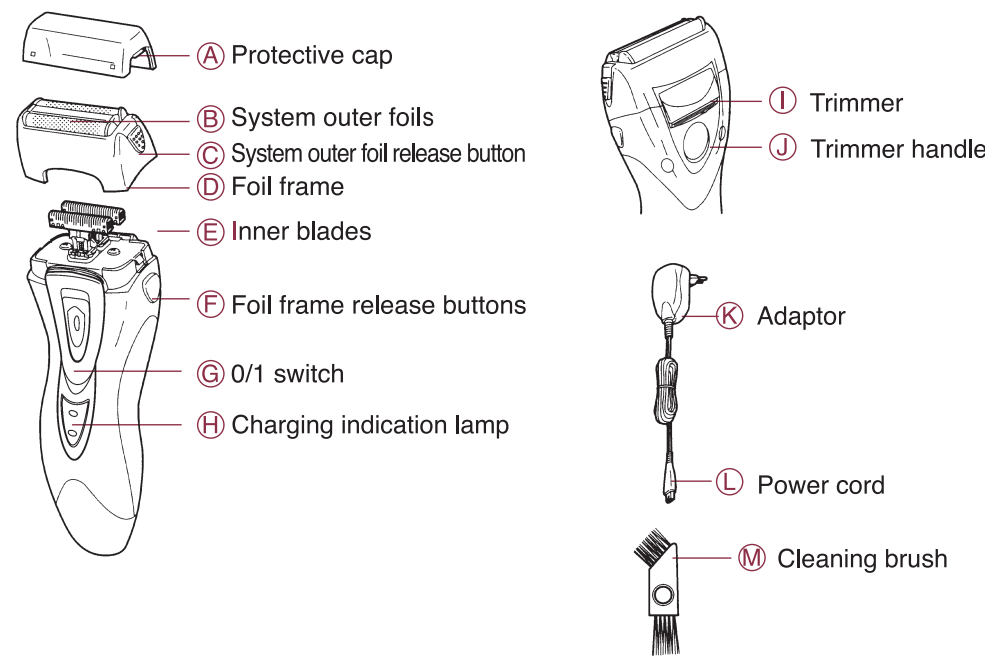

IMPORTANT SAFEGUARDS AND PRECAUTIONS



SAVE THESE INSTRUCTIONS

- CAUTION: This appliance is not to be used close to a bathtub, washbasin, or other containers holding water. Danger can arise even when the appliance is switched off, which is why the plug must be pulled out of the socket after it has been used and before it is cleaned. Never pull the plug out of the socket by tugging on the lead!
- If, however, the appliance should fall into water, pull the power plug out of the power socket immediately!
 - Never place your hand in the water!
 - Have your appliance checked by a qualified electrician before using it again.
- Ensure that your appliance does not get wet (water splashing, etc.) and do not use it with wet hands. If you put your appliance down whilst drying your hair, always switch it off as a precaution.
- Children do not realize the dangers arising from improper use of electrical appliances. Children should not therefore be allowed to use this appliance without supervision.
- Please read these operating instructions carefully and explain all necessary precautions to your children.
- Always unplug your appliance after use and before cleaning it!
- Improper repairs may place the user at serious risk.

SPARES AVAILABLE ON REQUEST

Contact: customerservice@lloytron.com or Tel. 08454 818808

If you find that over time usable parts become worn or damaged, then please contact our Customer Service Department above who can advise you if parts are available and any nominal cost to replacement the parts.

HOW TO USE

BEFORE USE:

- 1) Ensure the Shaver is fully charged before use, 8 hrs charging time.
- 2) Check the foil is not damaged and dirty before use.
- 3) Avoid damaging foil by pressing hard or striking it with hard substances. Damaged foils can score your skin and create abrasions.

CHARGING:

- 1) Turn OFF the switch before charging
- 2) Use the Charging Adaptor provided to fully charge the shaver.
- 3) Plug the charging lead into the bottom of the shaver.
- 4) Plug the adaptor into the power socket

To guarantee long life of the rechargeable battery, please observe the following guidelines.

- i) Charge and store the shaver at temperatures between 5C and 35C.
- ii) Do not allow the shaver to be connected for over 48 hours to the power supply.

SHAVING:

- 1) Ensure Shaver is properly charged.
- 2) Turn the Shaver ON.
Place the Shaver foil close to the skin and move fast in both circular and straight motions. (Fig.2.)
- 3) Care should be taken around moles and other skin blemishes.
- 4) Stretch the skin with your free hand to help straighten hair.
- 5) Hair on the neck can also be shaved this way.
- 6) After shaving, clean and place protective cap to prevent foil becoming damaged.

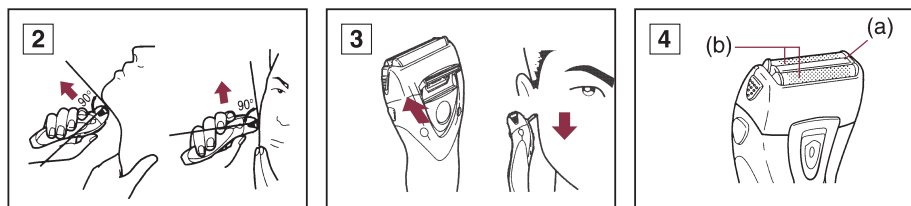

a) Inner Foil b) Outer Foils

TRIMMING:

At the rear of the Shaver is a Trimming Head for Sideburns, Moustache and beards etc.

- 1) Push switch up to engage the Trimmer.
- 2) Softly touch skin at right angles and slow trim downwards. (Fig. 3)
- 3) After using, Push switch down to disengage Trimmer.

CLEANING AND CARE

Maintenance

This appliance has been designed to operate over a long period of time with minimum of maintenance. Continuous satisfactory operation depends upon proper care and regular cleaning.

Storage

Always store this appliance and cord in a moisture-free area.
Do not wrap the cord of the charging adaptor around the appliance.
Do not store in temperatures above 35c.

Cleaning

Squeeze the two buttons on either side of the unit to remove Foil Frame.
Remove any hair debris using cleaning brush after each use.
Blow the debris from the cutting heads, if necessary, remove by pulling off the mechanism.
Click back into place after cleaning.
Rinse foils under running water and allow to dry naturally.
DO NOT USE A TOWEL ON THE FOIL!
A Mild detergent can be used in the head only.

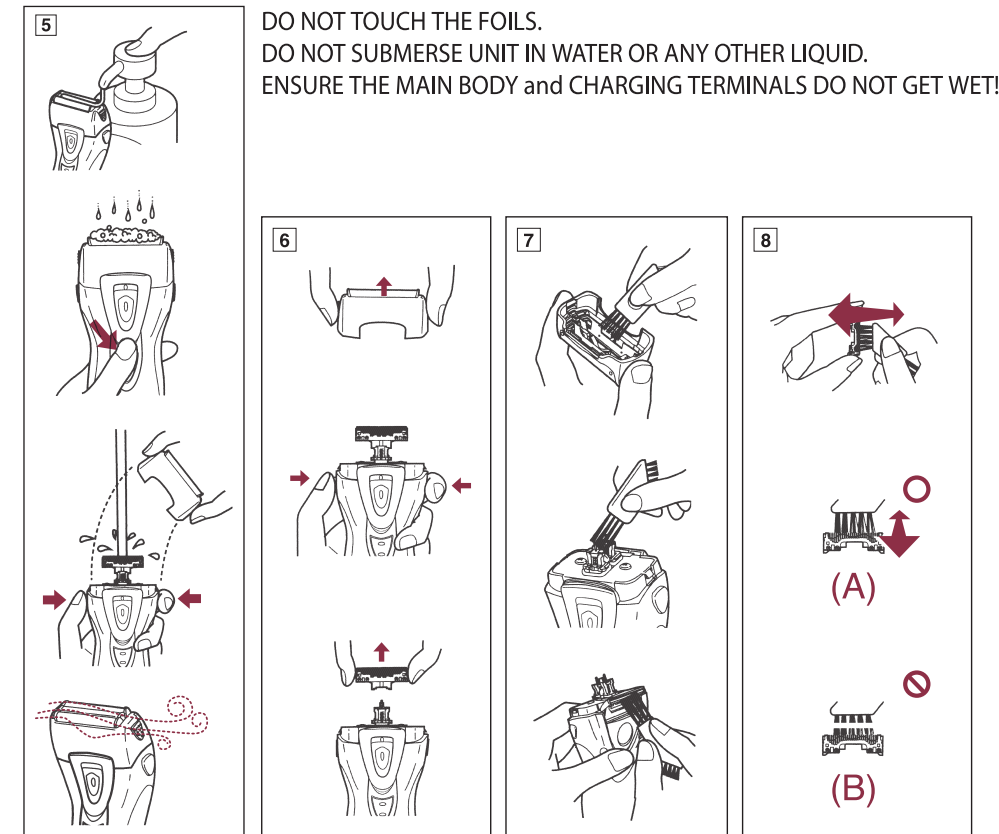

CAUTION!

This appliance is not intended for use by persons with reduced physical, sensory or mental capabilities, or lack of experience and knowledge, unless they have been given supervision or instruction concerning use of the appliance, by a person responsible for their safety.

WEEE / ENVIRONMENTAL PROTECTION



Disposal of Electrical and Electronic Equipment

Do not dispose of this product with household waste. For the proper treatment, recovery and recycling please take this product to the appropriate waste collection point. If you are unsure where this may be, please contact your local authority.
Improper disposal may be harmful to the environment.



Product End of Life and Battery Disposal

The built-in rechargeable battery contains substances that may pollute the environment. At end of life for the product, always remove the battery and separate before you discard the product at your local waste collection point. Both battery and product should be disposed separately.
If you have trouble removing the battery, then you should contact a qualified technician or authorised service centre.
Contact your local authority for details and locations of official waste collection points. Do not dispose of batteries or product with normal household waste.

Removing the Battery

Only remove the rechargeable battery at the time you wish to discard the product.
Ensure that the battery is completely discharged before attempting to remove it.
DO NOT remove the battery for any other purposes other than to dispose of the battery and the product separately at an Official Waste Collection Point at the end of the product's life.

1. Squeeze the Foil Frame Release Buttons to release the Foil Frame.
2. Located at the bottom of the unit, next to the Charging Connection, is a small screw. Release the screw using a cross-head screwdriver (Not Included) and remove the plastic cap.
3. Pry apart the 2 matt black plastic shells that make up the handle. This will expose 2 small screws at either side of the handle and one small screw at the bottom centre of the handle
4. Remove the screws using a cross-head screwdriver (Not Included).
5. Located next to the Trimmer Switch are 2 rubber pellets that cover 2 screw fixtures. Remove the pellets using a small, thin device such as a pin or paperclip, levering the pellets from the holes.
6. Release the screws using a cross-head screwdriver (Not Included).
7. Pry apart the case for the whole unit to expose the batteries and motor unit.
8. Remove the Batteries carefully and dispose of them separately from the product at an official waste disposal site.

DO Not connect the appliance to the charging adaptor after removing the batteries.

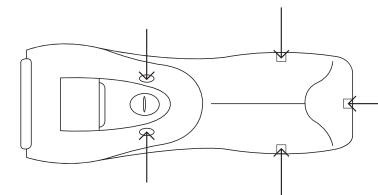

Made for Lloytron PLC, Leigh, Lancashire, UK WN7 3XH

For details of other great Lloytron products,
please see our website:

www.lloytron.com