

Paul
anthony™
exclusive to  LLOYTRON®

OPERATING INSTRUCTIONS

Pro Series 4 TITANIUM Rotary Shaver



MODEL: H5013BK

thank you

Thank you for the purchase of this quality **LLOYTRON** product. Used carefully and in accordance with the instructions enclosed, it should give you trouble free service over a long period of time. Please keep these instructions for future reference.

FEATURES

- Rechargeable Cordless Operation
- 4 Titanium Steel Flexible Heads
- Smooth Comfortable Shave
- Retractable Side Precision Trimmer
- Washable Head
- LED Power Indicator
- Charge Time: 8 Hours
- Usage: 40 Mins (approx.)
- AC Charging Adaptor (included)
- Colour: Black

LOCATION OF CONTROLS





IMPORTANT SAFEGUARDS AND PRECAUTIONS



SAVE THESE INSTRUCTIONS

- Save these instructions.
- Read all instructions carefully
- For Household Use only. Not intended for commercial use.
- Only for use indoors.
- Do not use outside or in damp conditions.
- Before plugging into mains socket, check whether supply line voltage and current rating are in compliance with the rated electrical parameters shown on the rating label.
- Keep away from hot surfaces, such as gas or electric hobs and ovens etc
- Do not use for any purposes other than the appliances intended use.
- This appliance is not intended to be operated by means of an external timer or separate remote control system.
- To prevent damage to the mains cord, do not let it pass over sharp corners, edges or hot surfaces.
- If the supply cord is damaged, do not use. Check before each use!
- If the supply cord is damaged, it must be replaced by a special cord or assembly available from the manufacturer or its service agent.
- Do not use if any part of this appliance is damaged in any way.
- Always unplug when not in use.
- To prevent against the risk of electric shock, do not submerge any part of this appliance in water, unless advised in this manual.
- This appliance should only be used on a flat surface.

- This appliance can be used by children aged from 8 years and above and persons with reduced physical, sensory or mental capabilities or lack of experience and knowledge if they have been given supervision or instruction concerning use of the appliance in a safe way and understand the hazards involved.
- Children shall not play with this appliance.
- Cleaning and user maintenance shall not be made by children without supervision.



- **WARNING!** Do not use this appliance near bathtubs, showers or other vessels containing water.
- When the appliance is used in a bathroom, unplug it after use since the proximity of water presents a hazard even when the appliance is switched off.
- Should this appliance fall into water, pull the plug out of the wall immediately. Do not place your hand in the water. The appliance should then be checked by a qualified electrician before use again!

HOW TO USE

BEFORE USE:

- 1) Ensure the Shaver is fully charged before use.
- 2) Check the foil is not damaged and dirty before use.
- 3) Avoid damaging foil by pressing hard or striking it with hard substances. Damaged foils can score your skin and create abrasions.



CHARGING:

- 1) Turn OFF the switch before charging
- 2) Use the Charging Adaptor provided to fully charge the shaver.
- 3) Plug the charging lead into the bottom of the shaver
- 4) Plug the adaptor into the power socket

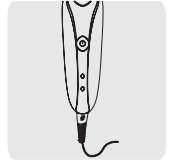

To guarantee long life of the rechargeable battery, please observe the following guidelines.

- i) Charge and store the shaver at temperatures between 5C and 35C.
- ii) Do not allow the shaver to be connected for over 48 hours to the power supply.

SHAVING:

- 1) Ensure Shaver is properly charged.
- 2) Turn the Shaver ON.
- 2) Place the Shaver foil close to the skin and move fast in both circular and straight motions.
- 3) Care should be taken around moles and other skin blemishes.
- 4) Stretch the skin with your free hand to help straighten hair.
- 5) Hair on the neck can also be shaved this way.
- 6) After shaving, clean and place protective cap to prevent foil becoming damaged.

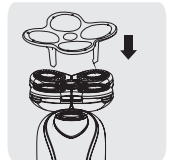

TRIMMING:

At the rear of the Shaver is a Trimming Head for Sideburns, Moustache and beards etc.

- 1) Push switch up to engage the Trimmer.
- 2) Softly touch skin at right angles and slow trim downwards.
- 3) After using, Push switch down to disengage Trimmer.

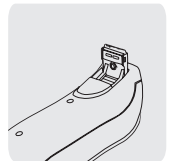

CLEANING AND CARE

MAINTENANCE

This appliance has been designed to operate over a long period of time with minimum of maintenance. Continuous satisfactory operation depends upon proper care and regular cleaning.

STORAGE

Always store this appliance and cord in a moisture-free area. Do not wrap the cord of the charging adaptor around the appliance. Do not store in temperatures above 35c.

CLEANING

Lift each of the 4 outer heads from the centre, one by one. Remove any hair debris using cleaning brush after each use. Rinse head only under running water and dry thoroughly with towel.

**DO NOT USE A TOWEL ON THE HEAD SURFACE.
DO NOT SUBMERSE UNIT IN WATER OR ANY OTHER LIQUID.**

Clean Trimmer Head with the soft brush. The whole head can be removed for easy cleaning in warm soapy water. Simply pull head away from body, and to replace click back.

NOTE: DO NOT USE HOT WATER AS THIS MAY DAMAGE THE FOILS.



LOW VOLTAGE POWER ADAPTOR

This product is supplied with a low voltage power adaptor. To avoid damaging the product do not use any other adaptor other than that supplied.

Specification: Input: 220-240v~ 50/60Hz
Output: 2.4v DC



LLOYTRON® CUSTOMER SERVICES

If you have any queries about this product, there are three ways to contact our customer service department:

call: 08454 81 8808

email: customerservice@lloytron.com

web: www.lloytronhelpdesk.com

To find more details on a wide range of Lloytron products please visit our website at www.lloytron.com
Lloytron plc, Laltex House, Leigh Commerce Park, Greenfold Way, Leigh, Lancashire, WN7 3XH. England, U.K