

Paul
anthony[®]

OPERATING INSTRUCTIONS

Pro Series T2

Beard & Shaver with Trimmer



MODEL: H5117BK

thank you

Thank you for the purchase of this quality **PAUL ANTHONY** product. Used carefully and in accordance with the instructions enclosed, it should give you trouble free service over a long period of time. Please keep these instructions for future reference.

FEATURES

- Rechargeable Cordless Operation
- Ergonomic, Easy to Use Lightweight Design
- Stainless steel Blades
- Integrated, Adjustable Blade Guard
- 20 Length Settings (0.5mm Increments)
- Powerful, Quiet Motor
- Charging Time: 8hrs (approx.)
- Usage Time: 40mins (approx.)
- LED Charging Indicator
- Set Includes Lubricating Oil, Cleaning Brush & 1.2m USB Cable

SPECIFICATIONS

Requires: USB Power Source 5v DC 1.0A to 2.0A

Ambient Temperature: 5°C - 23°C

Note: Do not operate at temperatures above or below this range. Failure to comply can cause damage to the product.

IMPORTANT SAFEGUARDS AND PRECAUTIONS

SAVE THESE INSTRUCTIONS

- Read all instructions carefully
- For Household Use only. Not intended for commercial use.
- Only for use indoors.

DO NOT

Do not use outside or in damp conditions.

- Before plugging into mains socket, check whether supply line voltage and current rating are in compliance with the rated electrical parameters shown on the rating label.
- Keep away from hot surfaces, such as gas or electric hobs and ovens etc

DO NOT

Do not use for any purposes other than the appliances intended use.



- This product is not intended to be operated by means of an external timer or separate remote control system.
- To prevent damage to the power cord, do not let it pass over sharp corners, edges or hot surfaces.
- If the power cord is damaged, do not use. Check before each use!

If the supply cord is damaged, it must be replaced by a special cord or assembly available from the manufacturer or its service agent.

 **DO NOT**

Do not use if any part of this appliance is damaged in any way.

- Always unplug when not in use.
- To prevent against the risk of electric shock, do not submerge any part of this appliance in water, unless advised in this manual.

- This appliance can be used by children aged from 8 years and above and persons with reduced physical, sensory or mental capabilities or lack of experience and knowledge if they have been given supervision or instruction concerning use of the appliance in a safe way and understand the hazards involved.
- Children shall not play with this appliance.
- Cleaning and user maintenance shall not be made by children unless they are older than 8 and supervised.
- Keep the appliance and its cord out of reach of children less than 8 years.





WARNING! Do not use this appliance near bathtubs, showers or other vessels containing water.

DO NOT

Do not use if any part of this appliance is damaged in any way.

WARNING

- Keep the appliance dry
 - Do not use this appliance near bathtubs, showers or other vessels containing water.
 - Detach the hand-held part of from the supply cord before cleaning it with water
 - Make sure the power adaptor does not get wet
 - Only use the power adaptor and accessories supplied
-
- Use, charge and store the appliance at temperatures between 5°C and 23°C.
 - The rechargeable battery contains substances that may pollute or be harmful to the environment. Always remove the battery before discarding the appliance. Dispose of the batteries at an official collection point for batteries or seek advice from your local government authority.



LOCATION OF CONTROLS



A - Removable Comb Guide Attachment

Use the comb guide attachment to vary the length of stubble when trimming. For an extremely close trim remove the comb guide attachment completely.

B - On/Off Switch

This operates the motor to begin shaving. Ensure that the On/Off Switch is set to 'off' before commencing charging; otherwise the unit will not charge.

C – Stainless Steel Blades

Ultra sharp blades oscillate rapidly for a smoother cut, whilst continuing to sharpen.

D - Rotary Bald Guard Adjustment dial

This allows users to have greater control over the trimming with different settings.

E - Power Indicator LED

The power indicator LED lights up when the charging contacts connect, indicating that the unit is charging. The LED does not turn off to indicate when charging is complete.



OPERATION

■ CHARGING THE UNIT

This Trimmer includes a USB Cable for a wider range of charging capabilities. Requires a USB power source 5v DC 1000mA to 2000mA.

- 1** **PLUG** the USB cable into any suitable USB power source.
- 2** **PLUG** the Micro USB Connector to the Input on the Trimmer (Located at the bottom of the Handle.)
- 3** The LED Charging Indicator will **LIGHT UP** to indicate that the unit is charging.
 - Charging time: 8 Hours (approx.)
 - Usage Time: 40mins (approx.)

Note: *The trimmer will not charge when it is switched On. Be sure to check that the 'On/Off switch' is set to 'Off' when commencing charging. If the LED Charging Indicator is not lit up, then the Unit will not charge.*

To guarantee long life of the rechargeable battery, please observe the following guidelines:

- I) Charge and store the shaver at temperatures between 5°C and 23°C.
- II) Do not allow the shaver to be connected to the charger for more than 20 hours. The LED charging indicator does not turn off or change colour to indicate when the battery is fully charged.



■ SHAVING

IMPORTANT: Prior to first use, test the trimmer on a small area of your arm or leg. If you experience any sensitivity or allergic reaction, discontinue use immediately. Do not use this trimmer on sensitive or irritated skin.

- 1** **TURN** the Trimmer 'On' by switching the 'On/Off' switch to the 'On' position.
- 2** **HOLD** the Trimmer at a 45 degree angle to the desired area and trim in the opposite direction of your hair growth.
- 3** Continue to **TRIM** until the hair is removed.



Note: For the cleanest hair removal, pull your skin taut with one hand while trimming.

⚠ WARNING

- Keep out of reach of children

■ USING THE ADJUSTABLE BLADE GUARD

This Trimmer has an Adjustable Blade Guard for extremely detailed trimming, ranging from 0.5mm to 10mm in increments of 0.5mm. This is integrated into the unit so that you don't have to keep track of multiple Blade Guards any more.

- 1** Starting at 0.5mm setting, **TWIST** the Blade Guard Adjustment Dial anti clockwise to **INCREASE** the length of the Blade Guard.
- 2** **DECREASE** the Length of the Blade guard by **TWISTING** the Blade Guard Adjustment Dial Clockwise until you have reached the desired setting.

Note: It is advisable to start trimming using a longer setting before decreasing the length, in order to achieve your desired beard length.

0.5mm – Suitable for Stubble and Detailed trimming

2mm - 5mm – Suitable for trimming Short Beards

6mm + - Suitable for tidying Long Beards

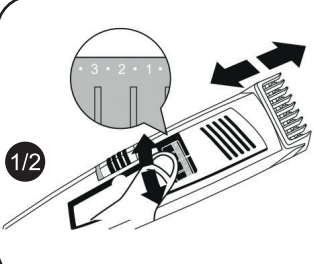

Setting	Hair Length after Trimming
1	3/64 in /1mm
2	5/64 in /2mm
3	1/8 in /3mm
4	5/32 in /4mm
5	3/16 in /6mm
7	9/32 in /7mm
8	5/16 in /8mm
9	3/8 in /9mm
10	13/32 in /10mm



CLEANING AND CARE

■ MAINTENANCE

This appliance has been designed to operate over a long period of time with minimum of maintenance. Continuous satisfactory operation depends upon proper care and regular cleaning.

Note: Water will cause damage to your trimmer. Do not use the Trimmer in a damp room or near water. When not in use, be sure the Trimmer is turned off.

■ STORAGE

Always store this appliance and cord in a moisture-free area. Do not wrap the cord of the charging adaptor around the appliance. Do not store in temperatures below 5°C or above 23°C. Failure to comply could result in damage to the product.

■ REMOVING & CLEANING THE BLADE GUARDS

- 1** **TURN** the Trimmer off.
- 2** **INCREASE** the Blade Guard Length fully by **TWISTING** the Blade Guard Adjustment Dial anti-clockwise until it reaches the 10mm setting, before attempting to remove the Blade Guard.
- 3** At the back of the unit, **PLACE** your thumb underneath the base of the Blade Guard and **GENTLY PUSH UP** in order to **SLIDE** the Blade Guard off of the unit.
- 4** Using the Cleaning bush provided, **GENTLY WIPE AWAY** any hair or dust from the Blade Guard and the Blades themselves.
- 5** **PUSH UP** against the blades to remove the blade unit from the body of the trimmer.
- 6** Using the Cleaning Brush provided, **GENTLY WIPE AWAY** any hair or dust from the blade unit.
- 7** **CAREFULLY RE-ATTACH** the Blade unit to the body of the trimmer until you hear it click securely into place.
- 8** Carefully **RE-ATTACH** the Blade Guard back into place by sliding it into the slots on the body of the unit until you hear it click securely into place.

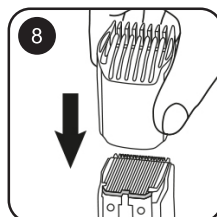
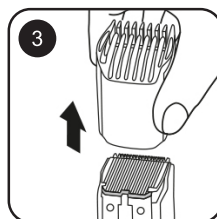

REMOVING THE BATTERY

1 Remove all of the exposed screws from the shaver and pry apart the casing to expose the battery.

2 Carefully cut the 2 wires one at a time using a sharp blade and remove the battery.

Note: *it is extremely important that you do not detach both wires at the same time using scissors, as this could short the battery, resulting in personal injury or damage to the battery.*

WEEE/ENVIRONMENTAL PROTECTION



■ DISPOSAL OF ELECTRICAL AND ELECTRONIC EQUIPMENT

Do not dispose of this product with household waste. For the proper treatment, recovery and recycling please take this product to the appropriate waste collection point. If you are unsure where this may be, please contact your local authority. Improper disposal may be harmful to the environment.



■ PRODUCT END OF LIFE AND BATTERY DISPOSAL

The rechargeable battery contains substances that may pollute the environment. At end of life for the product, always remove the battery and separate before you discard the product at your local waste collection point. Both battery and product should be disposed separately.

If you have trouble removing the battery, then you should contact a qualified technician or authorised service centre.

Contact your local authority for details and locations of official waste collection points. Do not dispose of batteries or product with normal household waste.







Paul
anthony CUSTOMER SERVICES

If you have any queries about this product then please contact Lloytron Customer Services online at:



www.lloytronhelpdesk.com

To find out more about Paul Anthony products, visit www.lloytron.com



Distributed in UK by Lloytron Plc, Laltex House, Leigh, England WN7 3XH
Distributed in Europe by Laltex Ireland Ltd, Dublin 2, D02 AY86