OPERATING INSTRUCTIONS

Travel Pro

Battery Operated Shaver with Trimmer Kit



NOTE: ONLY ONE MOTOR UNIT PROVIDED WITH THIS KIT.

MODEL: H5902

thank you

Thank you for the purchase of this quality **PAUL ANTHONY** product. Used carefully and in accordance with the instructions enclosed, it should give you trouble free service over a long period of time. Please keep these instructions for future reference.

FEATURES

SHAVER:

- Dual precision titanium steel floating blades
- 40 minute operation
- 2x AA Battery Operated
- Comfortable Ergonomic Grip
- Retractable Precision Trimmer

NOSE TRIMMER:

- Nasal and Ear Trimming Head
- Facial Hair Trimming Head for Moustache and Sideburns
- High Carbon Steel Blades
- LED Light Illumination
- Battery Operated (1 x AA 1.5v Alkaline Battery-Not Included)



SPECIFICATIONS

SHAVER:

Operating Voltage: 3v DC

Requires: 2x AA Alkaline Batteries

NOSE TRIMMER:

Operating Voltage: 1.5v DC

Requires: 1x AA Alkaline Battery

Do not use rechargeable or Heavy Duty/Carbon Zinc batteries

Ambient Operating Temperature: 5°C - 23°C

Note: Do not operate if ambient temperature is outside this range as this may damage the product.



www.lloytronhelpdesk.com

IMPORTANT SAFEGUARDS AND PRECAUTIONS

SAVE THESE INSTRUCTIONS

- Read all instructions carefully
- For Household Use only. Not intended for commercial use.
- Only for use indoors.
- To prevent against the risk of electric shock, do not submerge any part of this appliance in water, unless advised in this manual.

- Animal clipper, hair clipper and appliances for manicure and pedicure can be used by children aged from 3 years under supervision.
- Shaver, wet shaver, animal clipper, hair clipper, and appliances for manicure and pedicure can be used by children aged from 8 years and above and persons with reduced physical, sensory or mental capabilities or lack of experience and knowledge if they have been given supervision or instruction concerning use of the appliance in a safe way and understand the hazards involved.
- Children shall not play with this appliance.
- Cleaning and user maintenance shall not be made by children without supervision.



WARNING! Do not use this appliance near bathtubs, showers or other vessels containing water.

DO NOT

- Do not use for any purposes other than the appliances intended use.
- Do not use if any part of this appliance is damaged in any way.

WARNING

- Keep the appliance dry



LOCATION OF CONTROLS



A – Foil Head

The foil head protect the skin from being damaged by the titanium steel cutting blades.

B – Titanium Steel Cutting Blades

The blades oscillate rapidly to cut away at facial hair, giving a clean, smooth shave.

C – On/Off

This operates the motor to begin shaving. Ensure that the On/Off Switch is set to OFF before changing batteries

D – Nose & Ear Trimmer

Sharp rotating blades cut ear and nasal hair smoothly

E – Beard & Moustache Attachment

Additional attachment for the Nose Trimmer that transforms into a beard and moustache trimmer for easy styling

F – Travel Bag

Carry the full mens grooming products easily



OPERATION

■ SHAVER OPERATION

Check that batteries are inserted and correct polarity before commencing shaving.



1. Push the on/off switch to "ON" to operate the shaver.



2. Place the shaver foil close to the skin and move fast in circular and straight motions. Stretching the skin with your free hand will help to straighten the hair, making it easier to cut.

■ TRIMMING



1. Push the trimmer switch up to expose the trimmer.

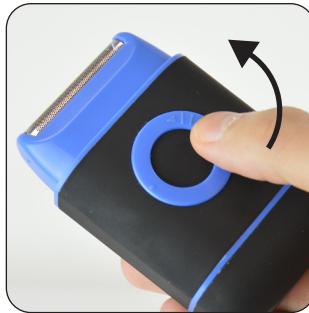

2. Push the on/off switch to the "ON" position to activate the trimmer blades.



3. Softly Touch the trimmer against the skin at a right angle and slowly trim downwards.





4. Push the on/off switch to the “OFF” position to disengage the trimmer blades.



5. Pull the trimmer switch to CLOSE the trimmer.

■ NOSE & EAR TRIMMER OPERATION

IMPORTANT: Prior to first use, test the trimmer on a small area of your arm or leg. If you experience any sensitivity or allergic reactions, discontinue use immediately. Do not use this trimmer on sensitive or irritated skin.

■ INSERTING/REPLACING THE BATTERY

1. TURN the **ON/OFF SWITCH** to the ‘OFF’ position. Whilst firmly holding the **CENTRE** part of the Nose Clipper **UPRIGHT**, **TWIST** the Battery Compartment Cover (located at the bottom of the unit) **CLOCKWISE** to expose the Battery Compartment.

2. REMOVE or **REPLACE** any old batteries if necessary. **ALWAYS ENSURE** you follow the correct polarity following the +/- signs. This unit uses 1 x AA 1.5v Alkaline Battery (Not Included).

3. REPLACE the Battery Cover by **TWISTING** the Battery Compartment Cover **ANTI-CLOCKWISE** until it **CLICKS** into place.

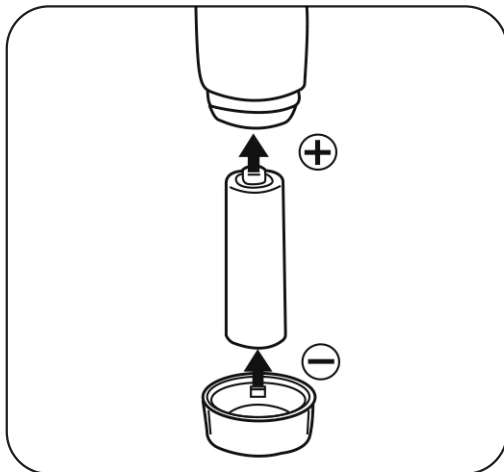

⚠ WARNING

Attempting to force the battery cover back on incorrectly may cause damage to the product.

IMPORTANT: To avoid damage to the Nose Clipper, be sure that the battery is inserted in the proper direction indicated by the +/- signs. If the Nose Clipper will not be used for a long period of time, remove the battery from the unit.



■ HOW TO USE

1. **REMOVE** the protective cap and turn the clipper '**ON**' by **PUSHING** the **ON/OFF SWITCH** to the '**ON**' position.
2. **GENTLY INSERT** the outer blade into the nostril or ear passage and **ROTATE** to cut hairs.
3. **DO NOT INSERT** beyond the outer blade or use **FORCEFULLY** within the nostrils or ear passages.
4. **CONTINUE** to use until the hair is **REMOVED**.
5. For moustache and sideburn trimming, **REMOVE** the nose and ear trimming head by **HOLDING** the unit **UPRIGHT** and **TWISTING** the head **ANTI-CLOCKWISE**. **TAKE** the facial hair trimming head and **CLIP** it into place by **TURNING** it **CLOCKWISE**.

WARNING

Attempting to force the trimming heads back on incorrectly may cause damage to the product.



CLEANING AND CARE

■ MAINTENANCE

This shaver has been designed to operate over a long period of time with minimum of maintenance. Continuous satisfactory operation depends upon proper care and regular cleaning.

■ STORAGE

Always store this shaver in a moisture-free area. Do not store in temperatures below 5°C or above 35°C.

■ SHAVER DISASSEMBLY FOR CLEANING

This Shaver comes with removable components, allowing for a more thorough and detailed clean, or the ability to replace blunt and damaged 'Cutting Blades' or 'Foil Heads'.

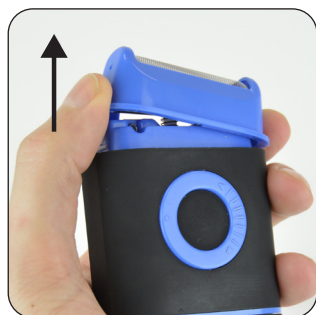

1. Gently hold the sides of the Head and pull up to release the Head Cover.

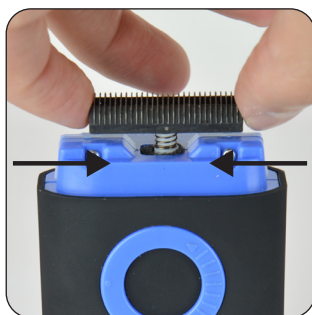

2. Each Foil Heads and Cutting Blades are held in place by an Inner Frame. Pull the Inner Frame catches to unclip them from the Head Cover.

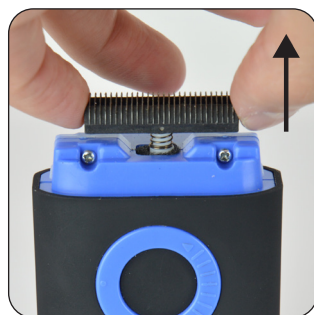

3. Remove the Foil by carefully pushing the top of the foil which will unclip from the head. Then extract the foil from inside the head.



4. Replace the foil by carefully pushing the cleaned or new foil inside the head unit until they click into place.



5. Remove the blades by pulling them up from the main unit. The blades are sat in a cradle and the whole cradle should be replaced.



6. The new blades push back into the holder. It doesn't matter which way round.





7. Clip the Head Cover back into place.



8. Place the plastic protective cover onto the head to protect the foil.

■ REMOVING THE BATTERY



1. Press the button at the back of the unit above the blue line to release the bottom of the shaver.



2. Remove the bottom of the shaver to reveal the battery compartment.



3. Insert the batteries in series, one positive down, one negative down. It doesn't matter which way round as long as they are inserted in different directions.



4. Close the cover.



WEEE/ENVIRONMENTAL PROTECTION



■ DISPOSAL OF ELECTRICAL AND ELECTRONIC EQUIPMENT

Do not dispose of this product with household waste. For the proper treatment, recovery and recycling please take this product to the appropriate waste collection point. If you are unsure where this may be, please contact your local authority. Improper disposal may be harmful to the environment.



■ PRODUCT END OF LIFE AND BATTERY DISPOSAL

The battery contains substances that may pollute the environment. At end of life for the product, always remove the battery and separate before you discard the product at your local waste collection point. Both battery and product should be disposed separately.

If you have trouble removing the battery, then you should contact a qualified technician or authorised service centre.

Contact your local authority for details and locations of official waste collection points. Do not dispose of batteries or product with normal household waste.





Paul
anthony CUSTOMER SERVICES

If you have any queries about this product then please contact Lloytron Customer Services online at:



www.lloytronhelpdesk.com

To find out more about Paul Anthony products, visit www.lloytron.com



Distributed in UK by Lloytron Plc, Laltex House, Leigh, England. WN7 3XH
Distributed in Europe by Laltex Ireland Ltd, Dublin 2, Eire. D02 AY86